



Benham&Reeves

Moore House, Grosvenor Waterside, SW1

£740 per week, £3,207 per month + fees

 1 Bedroom  1 Bathroom  Furnished

A fabulous 580 sq ft ONE BEDROOM apartment situated in Moore House on the GROSVENOR WATERSIDE development where residents benefit from 24 Hr CONCIERGE, an exquisite Health Club & Spa, local Coffee Shop & on-site Sainsbury's market.

Please [click here](#) for full detail

Property features

One Bedroom | Bathroom | Reception | 580 sq ft | Kitchen | EPC-B | Furnished | Health Club & Spa | 24 Hr Concierge | Sloane Square & Victoria Stations

For more information about this property,
please call our Knightsbridge branch on

020 7581 2112

Redress & Client Money Protection :

Benham and Reeves are members of The Property Ombudsman redress scheme and have Client Money protection with ARLA Propertymark. You can find more information on our website at <https://www.benhams.com/membership/>



Benham & Reeves

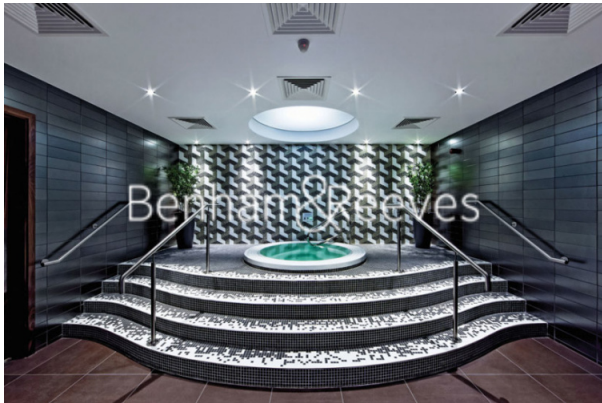

Moore House, Grosvenor Waterside, SW1

£740 per week, £3,207 per month + fees

www.benhams.com

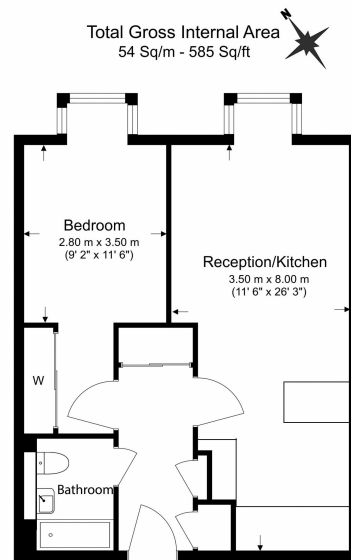

Benham & Reeves

Floor Plan measurements are approximate and are for illustrative purposes only. While we do not doubt the floor plans accuracy, we make no guarantee, warranty or representation as to the accuracy and completeness of the floor plan.

Score	Energy rating	Current	Potential
92+	A		
81-91	B	84 B	84 B
69-80	C		
55-68	D		
39-54	E		
21-38	F		
1-20	G		

London branches open six days a week Mon - Sat

Canary Wharf | City | Colindale | Dartmouth Park | Ealing | Fulham
Hammersmith | Hampstead | Highgate | Hyde Park | Kensington | Kew
Knightsbridge | Nine Elms | Shoreditch | Southall | Surrey Quays
Wapping | Wembley | White City | Woolwich

International offices

China | Hong Kong SAR | India | Indonesia | Qatar | Malaysia | Middle East |
Singapore | South Africa | Thailand | Turkey



Benham & Reeves