



Benham & Reeves

Benham & Reeves

Gladwin Tower, Nine Elms, SW8

£880 per week, £3,813 per month + fees

 2 Bedrooms  2 Bathrooms  Furnished

spacious modern 15th floor apartment situated within a popular development on Wandsworth Road ideally located for Waterloo, Victoria, Green Park, and Oxford Street with the Victoria Line. EPC-B

Please [click here](#) for full detail

Property features

Two double bedrooms | Two bathrooms | Balcony | Air cooling | Dishwasher | EPC-B | 24 hour concierge | Gym | Residence lounge | Nine Elms Tube Station

For more information about this property, please call our Nine Elms branch on

020 3282 3700

Redress & Client Money Protection :

Benham and Reeves are members of The Property Ombudsman redress scheme and have Client Money protection with ARLA Propertymark. You can find more information on our website at <https://www.benhams.com/membership/>



Benham & Reeves



Gladwin Tower, Nine Elms, SW8

£880 per week, £3,813 per month + fees

www.benhams.com

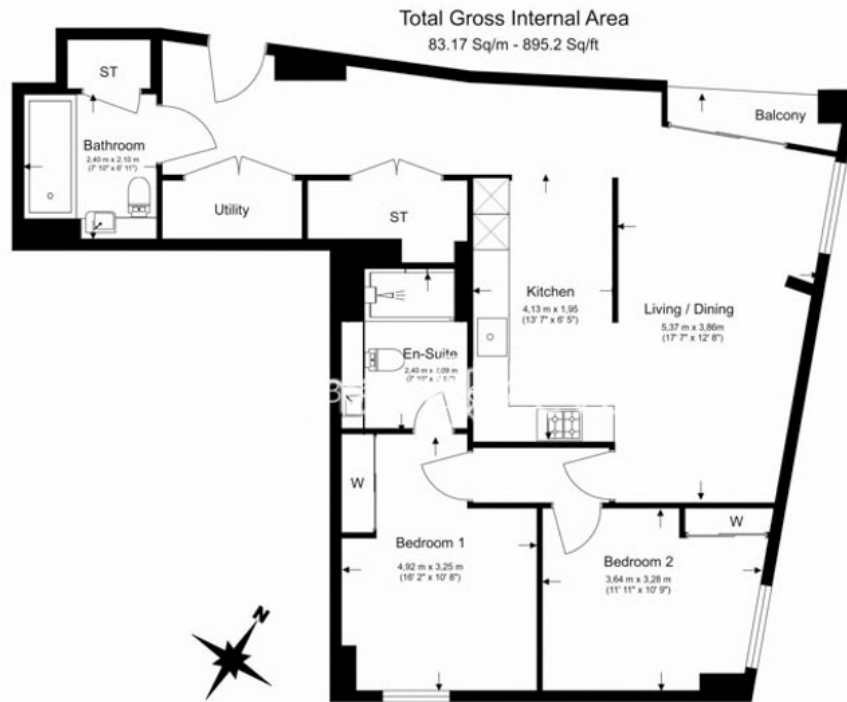

Floor Plan measurements are approximate and are for illustrative purposes only. While we do not doubt the floor plans accuracy, we make no guarantee, warranty or representation as to the accuracy and completeness of the floor plan.

Energy Efficiency Rating		
	Current	Potential
Very energy efficient - lower running costs		
(92-100) A		
(81-91) B	85	85
(69-80) C		
(55-68) D		
(39-54) E		
(21-38) F		
(1-20) G		
Not energy efficient - higher running costs		
England & Wales	EU Directive 2002/91/EC	

London branches open six days a week Mon - Sat

Canary Wharf | City | Colindale | Dartmouth Park | Ealing | Fulham
Hammersmith | Hampstead | Highgate | Hyde Park | Kensington | Kew
Knightsbridge | Nine Elms | Shoreditch | Southall | Surrey Quays
Wapping | Wembley | White City | Woolwich

International offices

China | Hong Kong SAR | India | Indonesia | Qatar | Malaysia | Middle East |
Singapore | South Africa | Thailand | Turkey



Benham & Reeves