



**Arena Tower, Crossharbour Plaza, Canary Wharf,**  
Offers in excess of: £500,000

 Benham  
& Reeves

# Arena Tower, Crossharbour Plaza, Canary Wharf, E14

 1 Bedroom     1 Bathroom     Leasehold

Positioned on the eleventh floor of the iconic Arena Tower, this outstanding one-bedroom apartment extends to over 665 sq. ft. and features a generous private south-west facing balcony with uninterrupted, far-reaching views across the Millwall inner dock, an outlook that is nothing short of spectacular.

Arena Tower is a striking, recently completed landmark development finished to an exceptional standard throughout. Residents benefit from an impressive suite of amenities, including a 24-hour concierge service, private cinema, and exclusive access to the renowned Nuffield Health gym. Facilities include a swimming pool, boxing ring, personal training studios, and on-site physiotherapy services.

The surrounding area offers a vibrant lifestyle with an excellent selection of shops, cafes, restaurants, and bars all within close proximity, alongside a convenient 24-hour supermarket. Canary Wharf is easily accessible on foot or via a short DLR journey.

Transport links are superb, with Crossharbour DLR station just moments away, providing fast and direct connections to Canary Wharf, Bank, and Greenwich. This exceptional apartment delivers a rare combination of luxury, convenience, and urban living at its finest.

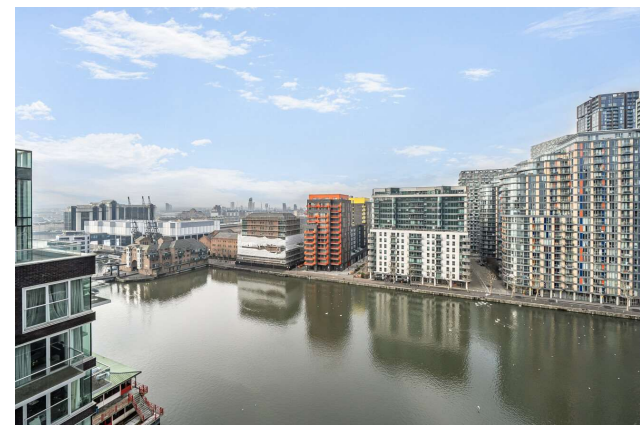



## Property Features:

- One Bedroom
- One Bathroom
- Wooden Flooring
- Eleventh Floor
- South-West Facing Large Balcony
- Millwall Inner Dock Views
- Gym, Spa and Boxing Ring
- 24h Concierge



## Crossharbour Plaza, Canary Wharf, E14

Approximate Area = 665 sq ft / 61.7 sq m  
For identification only - Not to scale

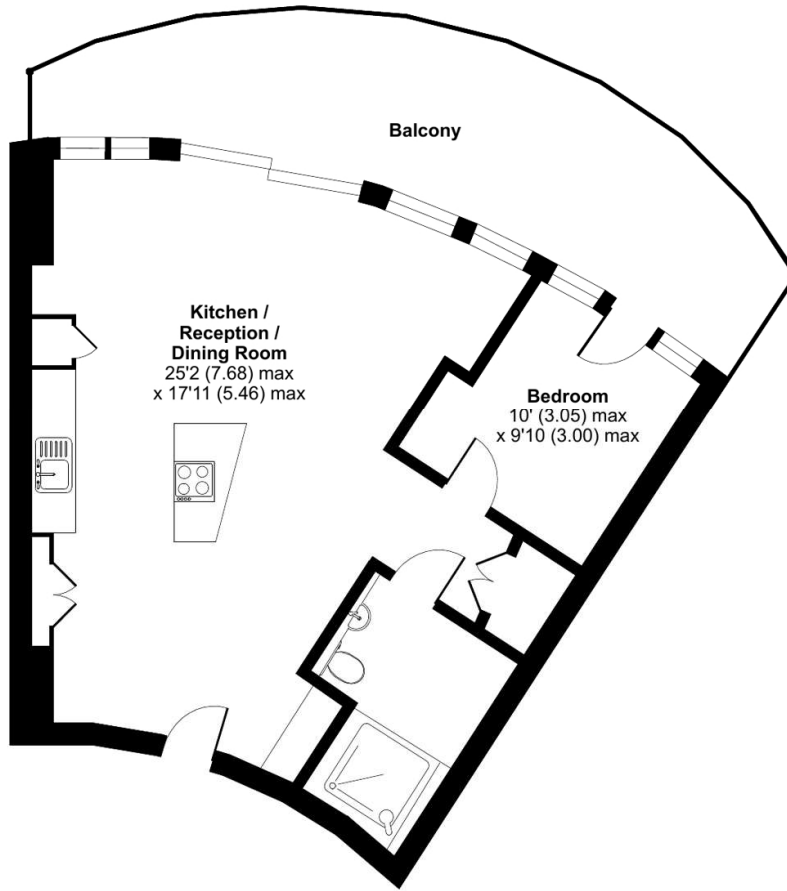

**ELEVENTH FLOOR**

Score	Energy rating	Current	Potential
92+	A		
81-91	B	82 B	82 B
69-80	C		
55-68	D		
39-54	E		
21-38	F		
1-20	G		

## Terms & Conditions:

These particulars are for guidance purposes only and do not form part of an offer or contract.

Offers in excess of: £500,000

Tenure: Leasehold  
Expires 01/01/3006  
Approximately 979 Years Remaining

Ground Rent: £500.00 (per annum)  
2026

Service Charge: £4,561.76 (per annum)  
for the year 2025

## Viewings:

All viewings are by appointment only through our Canary Wharf Office.

Our reference: CWH250384

T: 020 8036 3200

E: [canarywharf.sales@benhams.com](mailto:canarywharf.sales@benhams.com)

W: [www.benhams.com](http://www.benhams.com)

Disclaimer: These particulars are for guidance purposes only and do not form part of an offer or contract. Whilst care has been taken in their preparation, Benham and Reeves or the vendor shall not be held responsible for any inaccuracies. You should not rely on statements by Benham and Reeves Ltd in the particulars or by word of mouth or in writing as being factually accurate about the property, its condition or its value. Any areas, measurements or distances are approximate. The text, photographs and plans are for guidance only. The photographs appearing in these particulars show only certain parts of the property at the time when the photographs were taken. It should not be assumed that the property has all or any of the necessary planning permission, building regulation consent approval or other required consents for its previous, present or future intended usage. Any intending purchasers must satisfy themselves by inspection or by taking appropriate professional advice. Benham and Reeves Ltd has not rested any of the equipment, fittings or facilities.

London | Canary Wharf | City | Colindale | Dartmouth Park | Ealing | Fulham | Hampstead  
Hammersmith | Highgate | Hyde Park | Kensington | Kew | Knightsbridge | Nine Elms  
Surrey Quays | Shoreditch | Wembley | Wapping | White City | Woolwich

International | China | Hong Kong | India | Israel | Malaysia | Middle East | Pakistan  
Singapore | South Africa | Turkey

