



# Palmers House, Parr's Way, Hammersmith, W6

Asking Price: £604,500

 Benham  
& Reeves

# Palmers House, Parr's Way, Hammersmith, W6

 1 Bedroom (s)  1 Bathroom (s)  Leasehold

Introducing Fulham Reach, a prestigious riverside development perfectly positioned on the banks of the River Thames in the heart of Hammersmith. This vibrant neighbourhood blends contemporary architecture with landscaped green spaces, riverside promenades and a range of exceptional on-site amenities, creating one of West London's most desirable residential destinations.

This Manhattan-style apartment is located on the ground floor of an eight-storey building and offers approximately 488 square feet of thoughtfully designed internal space along with a large private terrace with a view over the landscaped gardens. The apartment features a well-planned open plan living, dining and sleeping area, complemented by a contemporary, fully integrated kitchen with high-quality appliances and sleek cabinetry. A modern bathroom and a large private terrace further enhance the home, providing a bright and comfortable living environment with valuable outdoor space.

Residents at Fulham Reach enjoy access to The Tamesis Club, an exclusive private residents' club offering an outstanding range of facilities including a swimming pool, sauna, steam room, treatment room, snooker room, cinema room, virtual golf room and Wi-Fi-enabled residents' lounge. The development is surrounded by beautifully landscaped parkland, private courtyards and a scenic river promenade, positioned between Frank Banfield Park and the River Thames. A variety of local amenities are also on site, including Tesco Express, Bread Lab Bakery, Charlotte's Cloud, The Blue Boat Bar, Brasserie Blanc, and the Caddi Club indoor golf experience.

The development benefits from excellent transport connections, with Hammersmith Station just a short walk away, providing access to the Piccadilly line, District line, Circle line, and Hammersmith & City line, offering convenient connections across London and beyond. Situated only a few miles from Central London, Fulham Reach combines riverside tranquillity with easy access to the capital's business, cultural and educational centres.





## Property Features:

- One Bedroom
- One Bathroom
- Ground Floor
- 488 Square Feet (Approx.)
- Luxury Manhattan Apartment
- Terrace
- Riverside Development
- Gym/Spa/Swimming Pool/Wine Tasting Room/Golf Room
- 24 Hour Concierge
- Hammersmith Station (Piccadilly Line, Zone 2)



Total Gross Internal Area  
45 Sq/m - 488 Sq/ft

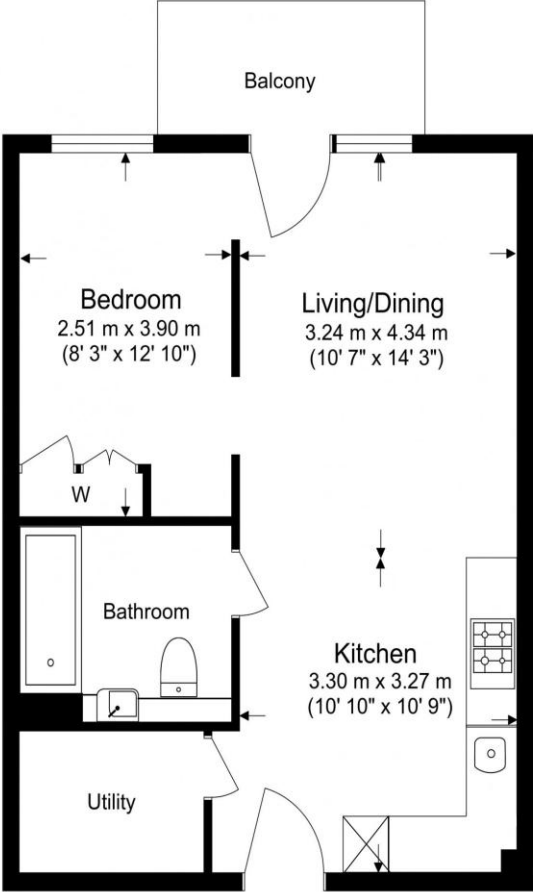

Floor Plan measurements are approximate and are for illustrative purposes only. While we do not doubt the floor plans accuracy, we make no guarantee, warranty or representation as to the accuracy and completeness of the floor plan.

## Terms & Conditions:

These particulars are for guidance purposes only and do not form part of an offer or contract.

Asking Price:	£604,500
Tenure:	Leasehold Expires 16/03/3010 Approximately 983 Years Remaining
Ground Rent:	Nil
Service Charge:	£3,106.00 (per annum) to completion
Anticipated Rent:	£2,600.00 pcm Approx. 5.2% Yield

## Viewings:

All viewings are by appointment only through our Hammersmith Office.

Our reference: KEN260056

T: 020 7938 3522

E: [hammersmith.sales@benhams.com](mailto:hammersmith.sales@benhams.com)

W: [www.benhams.com](http://www.benhams.com)

Disclaimer: These particulars are for guidance purposes only and do not form part of an offer or contract. Whilst care has been taken in their preparation, Benham and Reeves or the vendor shall not be held responsible for any inaccuracies. You should not rely on statements by Benham and Reeves Ltd in the particulars or by word of mouth or in writing as being factually accurate about the property, its condition or its value. Any areas, measurements or distances are approximate. The text, photographs and plans are for guidance only. The photographs appearing in these particulars show only certain parts of the property at the time when the photographs were taken. It should not be assumed that the property has all or any of the necessary planning permission, building regulation consent approval or other required consents for its previous, present or future intended usage. Any intending purchasers must satisfy themselves by inspection or by taking appropriate professional advice. Benham and Reeves Ltd has not rested any of the equipment, fittings or facilities.

London | Canary Wharf | City | Colindale | Dartmouth Park | Ealing | Fulham | Hampstead  
Hammersmith | Highgate | Hyde Park | Kensington | Kew | Knightsbridge | Nine Elms  
Surrey Quays | Shoreditch | Wembley | Wapping | White City | Woolwich

International | China | Hong Kong | India | Israel | Malaysia | Middle East | Pakistan  
Singapore | South Africa | Turkey

