



Oxford Gardens, Ladbroke Grove, London, W10

Asking Price: £525,000

 Benham
& Reeves

Oxford Gardens, Ladbroke Grove, London, W10

 1 Bedroom (s)  1 Bathroom (s)  Leasehold

This well-proportioned one-bedroom apartment is situated on a quiet North Kensington street. Spanning a sizeable 478 square feet (approx.), this 3rd floor apartment benefits from a spacious bedroom that overlooks the private gardens.

The apartment is well presented throughout, it comprises of a good-sized reception room, wood flooring and fully fitted open plan kitchen.

The local area benefits from trendy cafes, boutique shops as well as bars and restaurants. The property is close to the fashionable Portobello market. Ladbroke Grove underground station is also within close proximity.

Property Features:

- One Bedroom
- One Bathroom
- Third Floor
- 478 Square Feet (Approx.)
- Period Conversion
- Close Proximity to Portobello Road Market
- Ladbroke Grove Underground (Zone 2)



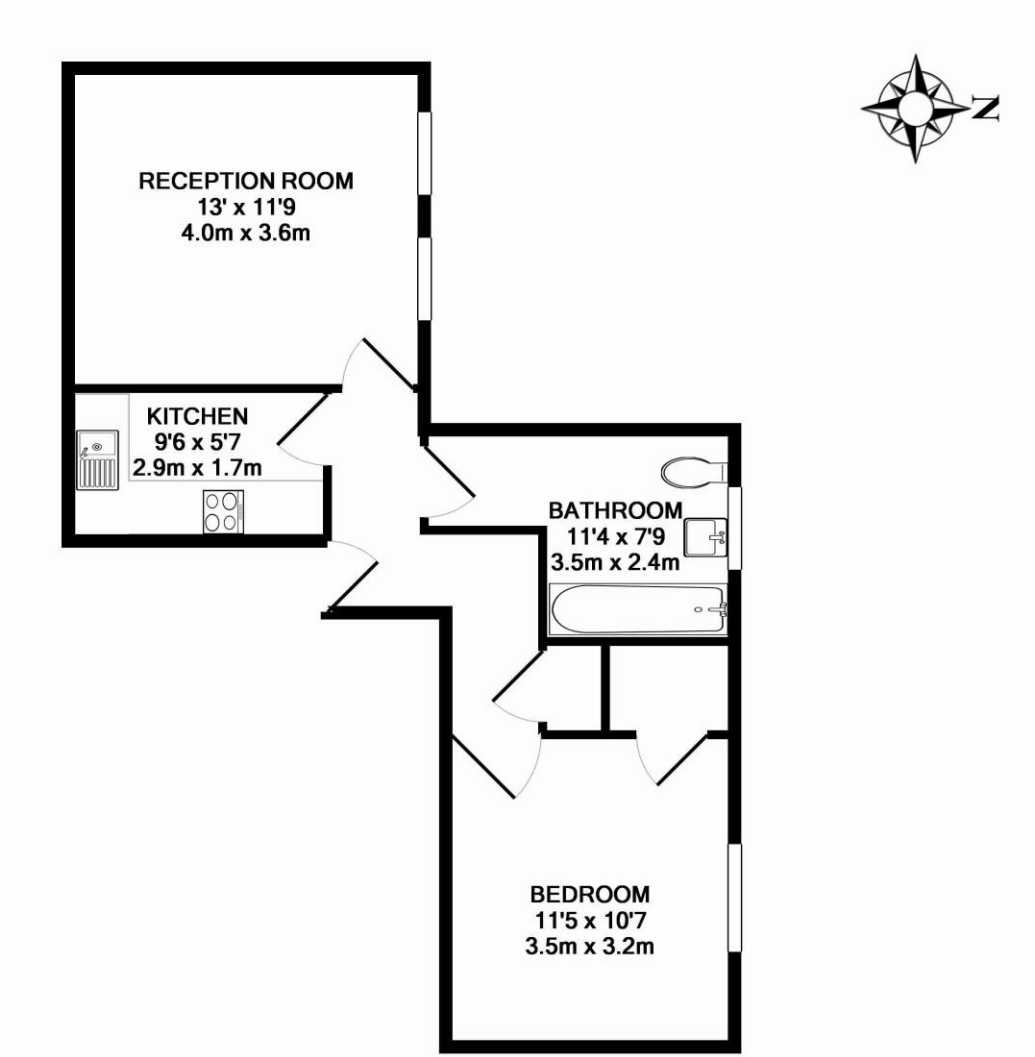

Energy Efficiency Rating		
	Current	Potential
Very energy efficient - lower running costs		
(92-100) A		
(81-91) B		
(69-80) C		
(55-68) D	63	70
(39-54) E		
(21-38) F		
(1-20) G		
Not energy efficient - higher running costs		
England, Scotland & Wales		EU Directive 2002/91/EC

00098-74OGK.W10 - 3RD FLOOR
TOTAL APPROX. FLOOR AREA 478 SQ.FT. (44.4 SQ.M.)

Whilst every attempt has been made to ensure the accuracy of the floor plan contained here, measurements of doors, windows, rooms and any other items are approximate and no responsibility is taken for any error, omission, or mis-statement. This plan is for illustrative purposes only and should be used as such by any prospective purchaser. The services, systems and appliances shown have not been tested and no guarantee as to their operability or efficiency can be given
Made with Metropix ©2015

Terms & Conditions:

These particulars are for guidance purposes only and do not form part of an offer or contract.

Asking Price: £525,000

Tenure: Leasehold
Expires 24/12/2176
Approximately 153 Years Remaining

Ground Rent: Nil

Service Charge: £463 (per annum) for the year 2023

Anticipated Rent: £1,300 pcm Approx.
Approx. 2.97% Yield

Viewings:

All viewings are by appointment only through our Kensington Office.

Our reference: BEA220573

T: 020 7938 3522

E: kensington.sales@benhams.com

W: www.benhams.com

Disclaimer: These particulars are for guidance purposes only and do not form part of an offer or contract. Whilst care has been taken in their preparation, Benham and Reeves or the vendor shall not be held responsible for any inaccuracies. You should not rely on statements by Benham and Reeves Ltd in the particulars or by word of mouth or in writing as being factually accurate about the property, its condition or its value. Any areas, measurements or distances are approximate. The text, photographs and plans are for guidance only. The photographs appearing in these particulars show only certain parts of the property at the time when the photographs were taken. It should not be assumed that the property has all or any of the necessary planning permission, building regulation consent approval or other required consents for its previous, present or future intended usage. Any intending purchasers must satisfy themselves by inspection or by taking appropriate professional advice. Benham and Reeves Ltd has not rested any of the equipment, fittings or facilities.

London

Canary Wharf
City
Colindale
Dartmouth Park
Ealing
Fulham
Hammersmith

Hampstead
Highgate
Hyde Park
Kensington
Kew
Knightsbridge
Nine Elms

Shoreditch
Surrey Quays
Wapping
White City
Woolwich

International

China
Hong Kong
India
Malaysia
Middle East
Singapore
South Africa

