



**Ward Road, Tufnell Park, N19**

Offers in excess of: £400,000

 Benham  
& Reeves

# Ward Road, Tufnell Park, N19

🛏 1 Bedroom (s)   🚿 1 Bathroom (s)   🔑 Leasehold

A generously proportioned apartment situated on the second floor of this purpose built block located less than 350 meters from Tufnell Park underground station (Northern Line).

This well presented property comprises an attractive 13'8 South facing reception room, a spacious double bedroom, stylish fitted kitchen with white high gloss units, and a tiled bathroom.

Ward Road is a peaceful residential turning positioned within easy reach of the wide selection of shops, restaurants and bars found along Fortress Road and Holloway Road. The green open spaces of Hampstead Heath are close by, as are excellent transport links including Kentish Town underground/National Rail station (Northern Line and Thameslink) and Gospel Oak overground station (Suffragette Line).







Fisher House Ward Road, London, N19

Approximate Area = 476 sq ft / 44.2 sq m  
For identification only - Not to scale

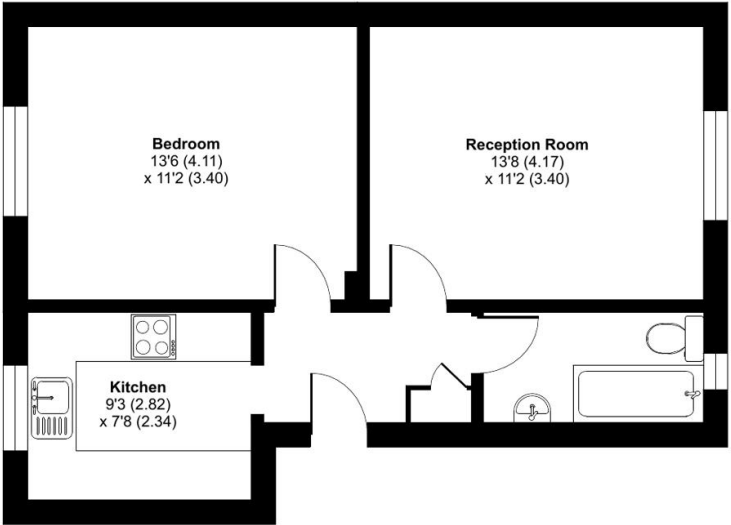

SECOND FLOOR

Score	Energy rating	Current	Potential
92+	A		
81-91	B		
69-80	C		78 C
55-68	D	67 D	
39-54	E		
21-38	F		
1-20	G		

## Terms & Conditions:

These particulars are for guidance purposes only and do not form part of an offer or contract.

Offers in excess of: £400,000

Tenure: Leasehold  
Expires 28/09/2962  
Approximately 937 Years Remaining

Ground Rent: £36.00 (per annum)  
2025

Service Charge: £2,370.00 (per annum)  
2025

## Viewings:

All viewings are by appointment only through our Dartmouth Park Office.

Our reference: DMP250061

T: 020 7319 9660

E: [dartmouthpark.sales@benhams.com](mailto:dartmouthpark.sales@benhams.com)

W: [www.benhams.com](http://www.benhams.com)

Disclaimer: These particulars are for guidance purposes only and do not form part of an offer or contract. Whilst care has been taken in their preparation, Benham and Reeves or the vendor shall not be held responsible for any inaccuracies. You should not rely on statements by Benham and Reeves Ltd in the particulars or by word of mouth or in writing as being factually accurate about the property, its condition or its value. Any areas, measurements or distances are approximate. The text, photographs and plans are for guidance only. The photographs appearing in these particulars show only certain parts of the property at the time when the photographs were taken. It should not be assumed that the property has all or any of the necessary planning permission, building regulation consent approval or other required consents for its previous, present or future intended usage. Any intending purchasers must satisfy themselves by inspection or by taking appropriate professional advice. Benham and Reeves Ltd has not rested any of the equipment, fittings or facilities.

London | Canary Wharf | City | Colindale | Dartmouth Park | Ealing | Fulham | Hampstead  
Hammersmith | Highgate | Hyde Park | Kensington | Kew | Knightsbridge | Nine Elms  
Surrey Quays | Shoreditch | Wembley | Wapping | White City | Woolwich

International | China | Hong Kong | India | Israel | Malaysia | Middle East | Pakistan  
Singapore | South Africa | Turkey

