



# Taylor House, Storehouse Mews, Westferry, E14

Asking Price: £300,000

 Benham  
& Reeves

# Taylor House, Storehouse Mews, Westferry, E14

 1 Bedroom  1 Bathroom  Leasehold

Set across the 1st floor of Taylor House, this well-presented apartment offers approximately 461 sq. ft. of accommodation and is ideally suited to a first-time buyer. The open-plan living room and kitchen area is spacious and thoughtfully designed, featuring modern fittings and appliances, with ample room for both dining and relaxation. The main living space also benefits from access to a private south-facing balcony. The bedroom is generously proportioned and filled with natural light from large double-glazed windows, while the contemporary three-piece bathroom suite is finished to a good standard.

Taylor House is situated on Garford Street, E14, providing excellent connectivity to Canary Wharf, with Westferry DLR station just 150 metres away. The DLR offers easy access to the City of London, Tower Hill, and Stratford for wider national rail connections. The Elizabeth line is also within approximately 0.5 km, offering fast and convenient links to the West End and Heathrow Airport.





## Property Features:

- One Bedroom
- Fob Gated Access
- 1st Floor Apartment
- Open-Plan Kitchen
- Private South-Facing Balcony
- Westferry DLR station
- Chain Free



# Taylor House, Storehouse Mews, Westferry, E14



## Storehouse Mews, London, E14

Approximate Area = 461 sq ft / 42.8 sq m  
For identification only - Not to scale

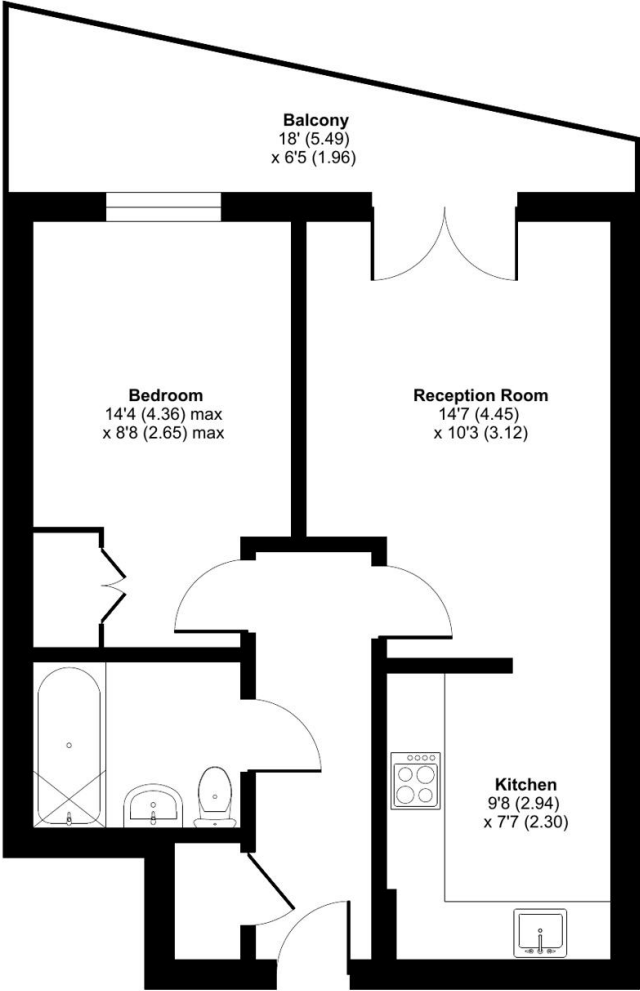

FIRST FLOOR

Score	Energy rating	Current	Potential
92+	A		
81-91	B	81 B	81 B
69-80	C		
55-68	D		
39-54	E		
21-38	F		
1-20	G		

## Terms & Conditions:

These particulars are for guidance purposes only and do not form part of an offer or contract.

Asking Price:	£300,000
Tenure:	Leasehold Expires 31/07/2132 Approximately 106 Years Remaining
Ground Rent:	£150.00 (per annum) For the year 2026
Service Charge:	£3,000.00 (per annum) Approximately for the year 2026

## Viewings:

All viewings are by appointment only through our Canary Wharf Office.

Our reference: CWH260107

T: 020 8036 3200

E: [canarywharf.sales@benhams.com](mailto:canarywharf.sales@benhams.com)

W: [www.benhams.com](http://www.benhams.com)

Disclaimer: These particulars are for guidance purposes only and do not form part of an offer or contract. Whilst care has been taken in their preparation, Benham and Reeves or the vendor shall not be held responsible for any inaccuracies. You should not rely on statements by Benham and Reeves Ltd in the particulars or by word of mouth or in writing as being factually accurate about the property, its condition or its value. Any areas, measurements or distances are approximate. The text, photographs and plans are for guidance only. The photographs appearing in these particulars show only certain parts of the property at the time when the photographs were taken. It should not be assumed that the property has all or any of the necessary planning permission, building regulation consent approval or other required consents for its previous, present or future intended usage. Any intending purchasers must satisfy themselves by inspection or by taking appropriate professional advice. Benham and Reeves Ltd has not rested any of the equipment, fittings or facilities.

London | Canary Wharf | City | Colindale | Dartmouth Park | Ealing | Fulham | Hampstead  
Hammersmith | Highgate | Hyde Park | Kensington | Kew | Knightsbridge | Nine Elms  
Surrey Quays | Shoreditch | Wembley | Wapping | White City | Woolwich

International | China | Hong Kong | India | Israel | Malaysia | Middle East | Pakistan  
Singapore | South Africa | Turkey

