



Kings Mill Way, Denham, Uxbridge, UB9

Price Reduced to: £392,000

Benham
& Reeves

Kings Mill Way, Denham, Uxbridge, UB9

 2 Bedroom (s)  2 Bathroom (s)  Leasehold

REF#: BEA240271

A contemporary two bedroom, two bathroom apartment located within the highly desirable Kings Island Waterside Development. Spanning an approximate 694 square feet and situated on the first floor, the layout includes a communal hallway with both lift and stair access, a welcoming hall, an open-plan living room with a dining area and access to a private south facing terrace and west facing balcony, a modern kitchen, a generously sized main bedroom with an en-suite shower room, a second double bedroom, and an additional bathroom.

Kings Island, a private gated community constructed by Weston Homes in 2013, is ideally positioned just off the Oxford Road, a brief stroll from Uxbridge Town Centre, which offers a variety of shopping options, dining establishments, bars, and access to the Metropolitan and Piccadilly line stations. Major roadways such as the A40/M40 and M25 are easily accessible, along with Hillingdon Hospital, Brunel University, Stockley Park, and Heathrow Airport. The area is served by several reputable primary and secondary schools, including grammar schools in Buckinghamshire.





Property Features:

- Two Bedroom Apartment
- Two Bathrooms
- Car Parking Space Included
- Circa. 694 Square Feet
- First Floor
- Large South Facing Terrace & West Facing Balcony
- Concierge Service
- Uxbridge Tube Station (Metropolitan & Piccadilly Lines)

Kings Mill Way, Denham, Uxbridge, UB9

Approximate Area = 694 sq ft / 64.4 sq m
For identification only - Not to scale

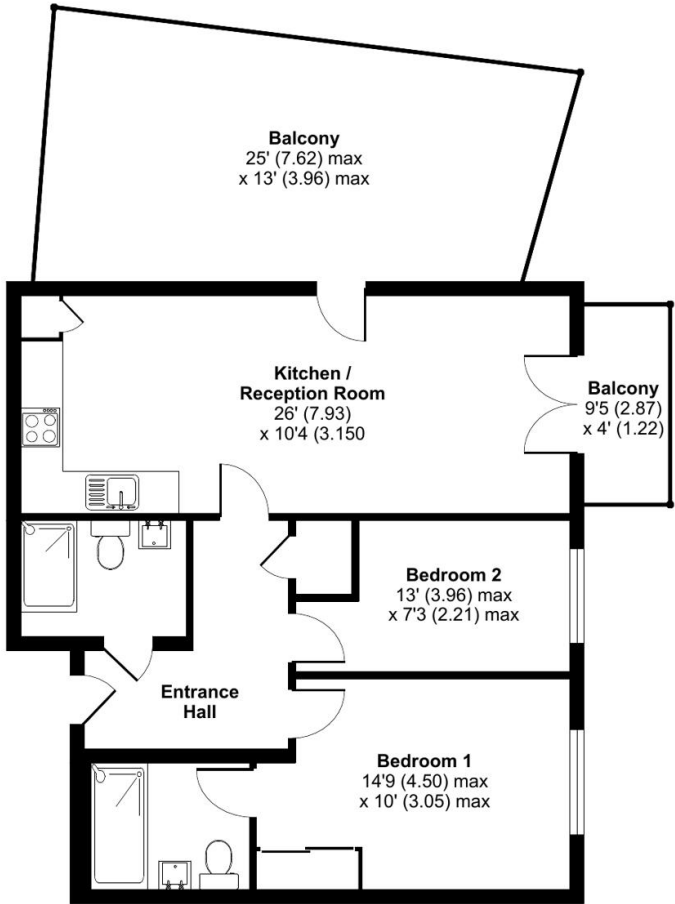

FIRST FLOOR

Energy Efficiency Rating		
	Current	Potential
Very energy efficient - lower running costs		
(92+) A		
(81-91) B		
(69-80) C	80	80
(55-68) D		
(39-54) E		
(21-38) F		
(1-20) G		
Not energy efficient - higher running costs		
England, Scotland & Wales	EU Directive 2002/91/EC	

Terms & Conditions:

These particulars are for guidance purposes only and do not form part of an offer or contract.

Price Reduced £392,000

to:

Tenure: Leasehold
Expires 31/08/3010
Approximately 985 Years Remaining

Ground Rent: £350.00 (per annum)
For the year 2025

Service Charge: £2,263.18 approx. (per annum)
For the year 2025

Anticipated Rent: £1,800.00 pcm
Approx. 5.5% Yield

Viewings:

All viewings are by appointment only through our Ealing Office.

Our reference: BEA240271

T: 020 8280 0140

E: ealing.sales@benhams.com

W: www.benhams.com

Disclaimer: These particulars are for guidance purposes only and do not form part of an offer or contract. Whilst care has been taken in their preparation, Benham and Reeves or the vendor shall not be held responsible for any inaccuracies. You should not rely on statements by Benham and Reeves Ltd in the particulars or by word of mouth or in writing as being factually accurate about the property, its condition or its value. Any areas, measurements or distances are approximate. The text, photographs and plans are for guidance only. The photographs appearing in these particulars show only certain parts of the property at the time when the photographs were taken. It should not be assumed that the property has all or any of the necessary planning permission, building regulation consent approval or other required consents for it previous, present or future intended usage. Any intending purchasers must satisfy themselves by inspection or by taking appropriate professional advice. Benham and Reeves Ltd has not rested any of the equipment, fittings or facilities.

London | Canary Wharf | City | Colindale | Dartmouth Park | Ealing | Fulham | Hampstead
Hammersmith | Highgate | Hyde Park | Kensington | Kew | Knightsbridge | Nine Elms
Surrey Quays | Shoreditch | Wembley | Wapping | White City | Woolwich

International | China | Hong Kong | India | Israel | Malaysia | Middle East | Pakistan
Singapore | South Africa | Turkey

