



Quinton Court, Plough Way, Rotherhithe, SE16

Asking Price: £585,000



Quinton Court, Plough Way, Rotherhithe, SE16

 2 Bedroom (s)  2 Bathroom (s)  Leasehold

Introducing this spacious two bedroom, two bathroom apartment with parking situated within the esteemed Marine Wharf development at Quinton Court.

Offering approximately 905 square feet of living space, this contemporary gem seamlessly combines comfort and elegance. The residence features an exquisitely designed open-plan kitchen and living area, granting access to a private balcony. The primary bedroom boasts an en-suite bathroom and fitted wardrobes, while an additional double bedroom and a family bathroom provide ample accommodation. Abundant hallway storage enhances the practicality of this sophisticated space.

Residents of Marine Wharf enjoy exclusive access to a fitness and leisure suite, complemented by the convenience of a 24-hour concierge service. Furthermore, the prime location ensures excellent transportation links to Canary Wharf, the City and Central London via nearby Surrey Quays & Canada Water stations. Experience modern living at its finest in this exquisite apartment.





Property Features:

- Parking
- Two Bedrooms
- Two Bathrooms
- 905 Square Feet (Approx.)
- Private South Facing Balcony
- 24-Hour Concierge
- Communal Gardens & Water Gardens
- Residents' Gym & Lobby
- Nelson Dock Pier: 0.4 miles, Surrey Quays Station (0.5 miles), Canada Water Station (0.9 miles) and Rotherhithe Station (1.2 miles)



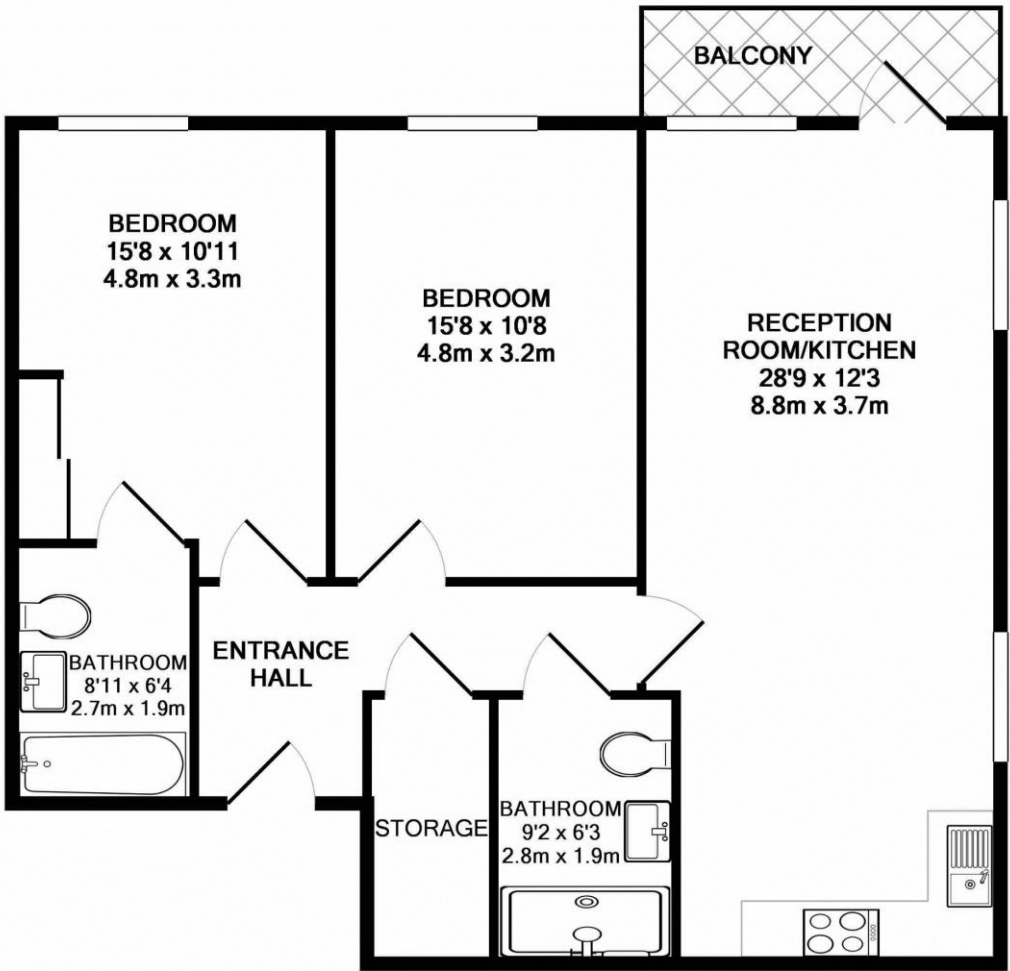

Energy Efficiency Rating		
	Current	Potential
Very energy efficient - lower running costs		
(92+) A		
(81-91) B	86	86
(69-80) C		
(55-68) D		
(39-54) E		
(21-38) F		
(1-20) G		
Not energy efficient - higher running costs		
England, Scotland & Wales	EU Directive 2002/91/EC	

PW.SE16 - 3RD FLOOR
 TOTAL APPROX. FLOOR AREA 905 SQ.FT. (84.0 SQ.M.)

Whilst every attempt has been made to ensure the accuracy of the floor plan contained here, measurements of doors, windows, rooms and any other items are approximate and no responsibility is taken for any error, omission, or mis-statement. This plan is for illustrative purposes only and should be used as such by any prospective purchaser. The services, systems and appliances shown have not been tested and no guarantee as to their operability or efficiency can be given

Made with Metropix ©2017

Terms & Conditions:

These particulars are for guidance purposes only and do not form part of an offer or contract.

Asking Price:	£585,000
Tenure:	Leasehold Expires 01/01/3016 Approximately 989 Years Remaining
Ground Rent:	£500.00 (per annum) Review period: 10 years Next: 2032 Increase: By RPI for the relevant year(s)
Service Charge:	£5,664.70 (per annum) to June 2026
Anticipated Rent:	£3,000.00 pcm Approx. 6.2 % Yield

Viewings:

All viewings are by appointment only through our Surrey Quays Office.

Our reference: KEN240040

T: 020 7740 3050

E: surreyquays.sales@benhams.com

W: www.benhams.com

Disclaimer: These particulars are for guidance purposes only and do not form part of an offer or contract. Whilst care has been taken in their preparation, Benham and Reeves or the vendor shall not be held responsible for any inaccuracies. You should not rely on statements by Benham and Reeves Ltd in the particulars or by word of mouth or in writing as being factually accurate about the property, its condition or its value. Any areas, measurements or distances are approximate. The text, photographs and plans are for guidance only. The photographs appearing in these particulars show only certain parts of the property at the time when the photographs were taken. It should not be assumed that the property has all or any of the necessary planning permission, building regulation consent approval or other required consents for its previous, present or future intended usage. Any intending purchasers must satisfy themselves by inspection or by taking appropriate professional advice. Benham and Reeves Ltd has not rested any of the equipment, fittings or facilities.

London | Canary Wharf | City | Colindale | Dartmouth Park | Ealing | Fulham | Hampstead
Hammersmith | Highgate | Hyde Park | Kensington | Kew | Knightsbridge | Nine Elms
Surrey Quays | Shoreditch | Wembley | Wapping | White City | Woolwich

International | China | Hong Kong | India | Israel | Malaysia | Middle East | Pakistan
Singapore | South Africa | Turkey

