



# Commercial Road, Westferry, E14

Asking Price: £425,000

Benham  
& Reeves

# Commercial Road, Westferry, E14

 2 Bedrooms    2 Bathrooms    Leasehold

Presenting this immaculate and beautifully refurbished third-floor apartment, ideally positioned just a short stroll from Westferry DLR and the vibrant Canary Wharf financial district.

Finished to a high contemporary standard throughout, the property is filled with natural light and offers a bright, welcoming atmosphere in every room. Elegant laminate flooring runs seamlessly throughout, complemented by a fully modernised family bathroom and a stylish, well-appointed interior.

The apartment has been meticulously maintained, creating a perfect balance of comfort and modern living. The accommodation comprises two spacious double bedrooms alongside a stunning open-plan kitchen and living area, designed for both relaxation and entertaining. The sleek contemporary kitchen features a breakfast bar, adding both style and practicality to the space.

Further benefits include secure allocated parking, a rare and highly desirable addition in this prime location.

A truly unique apartment in the heart of E14, offering high-quality living within one of London's most sought-after and well-connected neighbourhoods.





## Property Features:

- Two Double Bedrooms
- Reception/Open-Plan Kitchen
- Modern Finish
- 3rd Floor
- Breakfast Bar
- Allocated Parking
- Westferry DLR station



3rd Floor  
 Total Gross Internal Area  
 77 Sq/m - 827 Sq/ft

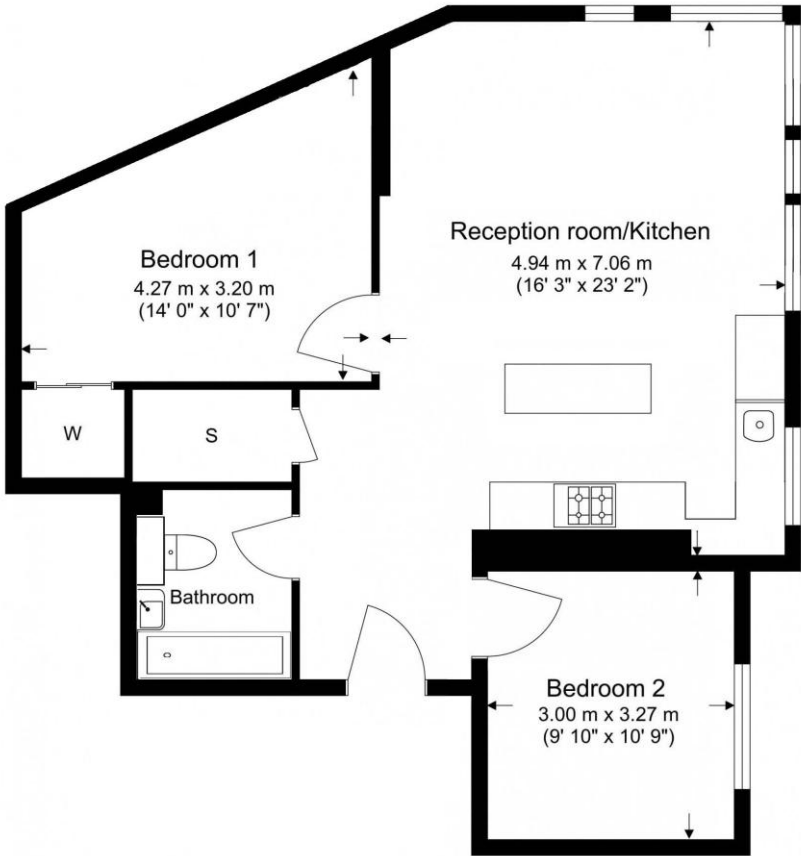

Score	Energy rating	Current	Potential
92+	A		
81-91	B		
69-80	C	77 C	77 C
55-68	D		
39-54	E		
21-38	F		
1-20	G		



Floor Plan measurements are approximate and are for illustrative purposes only. While we do not doubt the floor plans accuracy, we make no guarantee, warranty or representation as to the accuracy and completeness of the floor plan.

## Terms & Conditions:

These particulars are for guidance purposes only and do not form part of an offer or contract.

Asking Price:	£425,000
Tenure:	Leasehold Expires 17/02/2143 Approximately 116 Years Remaining
Ground Rent:	£250.00 (per annum) For the year 2026
Service Charge:	£1,836.00 (per annum) For the year 2026

## Viewings:

All viewings are by appointment only through our Canary Wharf Office.

Our reference: CWH260068

T: 020 8036 3200

E: [canarywharf.sales@benhams.com](mailto:canarywharf.sales@benhams.com)

W: [www.benhams.com](http://www.benhams.com)

Disclaimer: These particulars are for guidance purposes only and do not form part of an offer or contract. Whilst care has been taken in their preparation, Benham and Reeves or the vendor shall not be held responsible for any inaccuracies. You should not rely on statements by Benham and Reeves Ltd in the particulars or by word of mouth or in writing as being factually accurate about the property, its condition or its value. Any areas, measurements or distances are approximate. The text, photographs and plans are for guidance only. The photographs appearing in these particulars show only certain parts of the property at the time when the photographs were taken. It should not be assumed that the property has all or any of the necessary planning permission, building regulation consent approval or other required consents for its previous, present or future intended usage. Any intending purchasers must satisfy themselves by inspection or by taking appropriate professional advice. Benham and Reeves Ltd has not rested any of the equipment, fittings or facilities.

London | Canary Wharf | City | Colindale | Dartmouth Park | Ealing | Fulham | Hampstead  
Hammersmith | Highgate | Hyde Park | Kensington | Kew | Knightsbridge | Nine Elms  
Surrey Quays | Shoreditch | Wembley | Wapping | White City | Woolwich

International | China | Hong Kong | India | Israel | Malaysia | Middle East | Pakistan  
Singapore | South Africa | Turkey

