



Thalia House, Thunderer Walk, Woolwich, SE18

Price Reduced to: £575,000

 Benham
& Reeves

Thalia House, Thunderer Walk, Woolwich, SE18

 2 Bedroom (s)  2 Bathroom (s)  Leasehold

A splendid two bedroom, two bathroom apartment located in Thalia House, Royal Arsenal Riverside. Situated on the third floor and spanning approximately 759 square feet, this spacious apartment comprises an open-plan living room with a modern kitchen featuring integrated appliances. The main bedroom has an en-suite bathroom, there is a second double bedroom, and a shower room. Additional benefits include wooden flooring throughout and ample storage.

Residents of Royal Arsenal Riverside are served by a host of amenities, including a residents' gym, swimming pool, and concierge, as well as being positioned within walking distance of the River Thames. There is an on-site Marks & Spencer, a large Tesco supermarket, and direct access to the Elizabeth Line.

Locally, there is a bustling high street featuring a mix of chain and independent shops, restaurants, and health facilities, including a pharmacy and a GP surgery.

Woolwich Arsenal DLR, Elizabeth Line, and Thames Clipper Pier provide excellent transport links across London



Thalia House, Thunderer Walk, Woolwich, SE18



Property Features:

- Chain Free
- Two Bedrooms
- Two Bathrooms
- 3rd Floor
- 759 Square Feet (Approx.)
- Balcony
- Parking
- Cinema and Swimming Pool
- Residents' Gym and 24-Hour Concierge
- On-site Elizabeth Line Station
- Woolwich Overground and DLR Station



Thalia House, Thunderer Walk, Woolwich, SE18

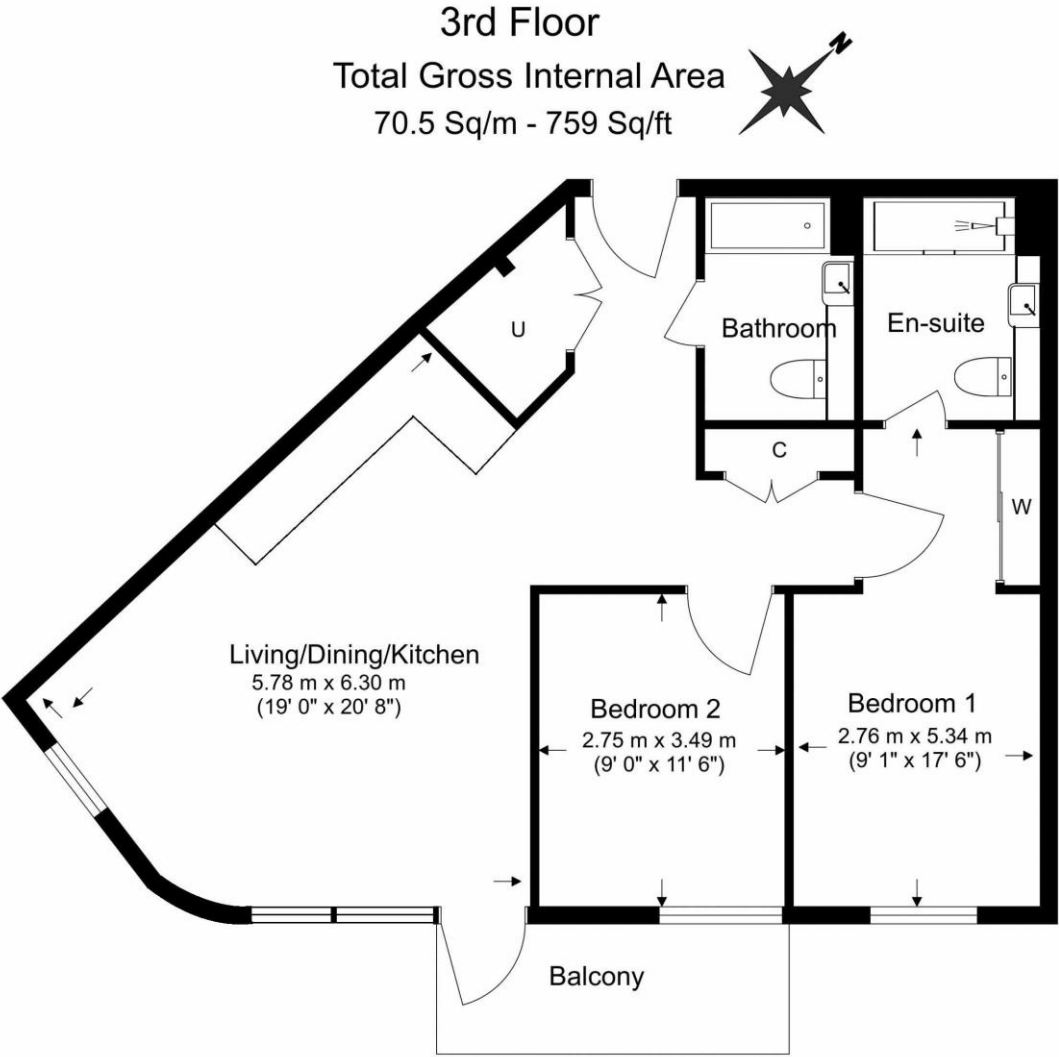

Floor Plan measurements are approximate and are for illustrative purposes only. While we do not doubt the floor plans accuracy, we make no guarantee, warranty or representation as to the accuracy and completeness of the floor plan.

Energy Efficiency Rating		
	Current	Potential
Very energy efficient - lower running costs		
(92+) A		
(81-91) B	86	86
(69-80) C		
(55-68) D		
(39-54) E		
(21-38) F		
(1-20) G		
Not energy efficient - higher running costs		
England, Scotland & Wales	EU Directive 2002/91/EC	

Terms & Conditions:

These particulars are for guidance purposes only and do not form part of an offer or contract.

Price Reduced to: £575,000

Tenure: Leasehold
Expires 31/12/3015
Approximately 990 Years Remaining

Ground Rent: £475.00 (per annum)
Increase: By RPI for the relevant year

Service Charge: £4,411.56 (per annum)
for the year 2025

Anticipated Rent: £2,500.00 pcm
Approx. 4.9% Yield

Viewings:

All viewings are by appointment only
through our Woolwich Office.

Our reference: WOO240125

T: 020 8051 0700

E: woolwich.sales@benhams.com

W: www.benhams.com

Disclaimer: These particulars are for guidance purposes only and do not form part of an offer or contract. Whilst care has been taken in their preparation, Benham and Reeves or the vendor shall not be held responsible for any inaccuracies. You should not rely on statements by Benham and Reeves Ltd in the particulars or by word of mouth or in writing as being factually accurate about the property, its condition or its value. Any areas, measurements or distances are approximate. The text, photographs and plans are for guidance only. The photographs appearing in these particulars show only certain parts of the property at the time when the photographs were taken. It should not be assumed that the property has all or any of the necessary planning permission, building regulation consent approval or other required consents for its previous, present or future intended usage. Any intending purchasers must satisfy themselves by inspection or by taking appropriate professional advice. Benham and Reeves Ltd has not rested any of the equipment, fittings or facilities.

London | Canary Wharf | City | Colindale | Dartmouth Park | Ealing | Fulham | Hampstead
Hammersmith | Highgate | Hyde Park | Kensington | Kew | Knightsbridge | Nine Elms
Surrey Quays | Shoreditch | Wembley | Wapping | White City | Woolwich

International | China | Hong Kong | India | Israel | Malaysia | Middle East | Pakistan
Singapore | South Africa | Turkey

