



Imperial Building, Duke of Wellington Avenue, Woolwich, SE18

Guide Price: £500,000

 Benham
& Reeves

Imperial Building, Duke of Wellington Avenue, Woolwich, SE18

 2 Bedroom (s)  2 Bathroom (s)  Leasehold

Located in Imperial Building, Royal Arsenal Riverside is this thoughtfully designed two bedroom, two bathroom apartment. Situated on the third floor and spanning approximately 790 square feet, featuring a spacious open-plan-kitchen and living area with a private balcony showing partial river views. The main bedroom benefits from a built-in wardrobe and an en-suite bathroom. There is a second double bedroom with ample lighting and space, and a family three-piece bathroom. Additional benefits include access to the balcony from each bedroom, providing plenty of natural light throughout the day, and extra storage space.

Residents of Royal Arsenal Riverside enjoy premium amenities, including a private gym, and concierge service. Ideally located near the River Thames, the development offers both convenience and scenic views. Nearby, you'll find Marks & Spencer, a large Tesco, and a vibrant high street with popular chains, independent shops, and restaurants. Essential services such as a pharmacy and GP practice are also close at hand.

Excellent transport links are also conveniently close at hand, including Woolwich Arsenal DLR and National Rail stations, as well as the Elizabeth Line for swift access to Central London and beyond.





Property Features:

- Two Bedrooms
- Two Bathrooms
- Third Floor
- 790 Square Feet (Approx.)
- Balcony
- Open-Plan Kitchen
- Secure Underground Parking
- Residents' Gym and 24-Hour Concierge
- Woolwich Overground and DLR Station
- Elizabeth Line



3rd Floor
 Total Gross Internal Area
 73.4 Sq/m - 790 Sq/ft

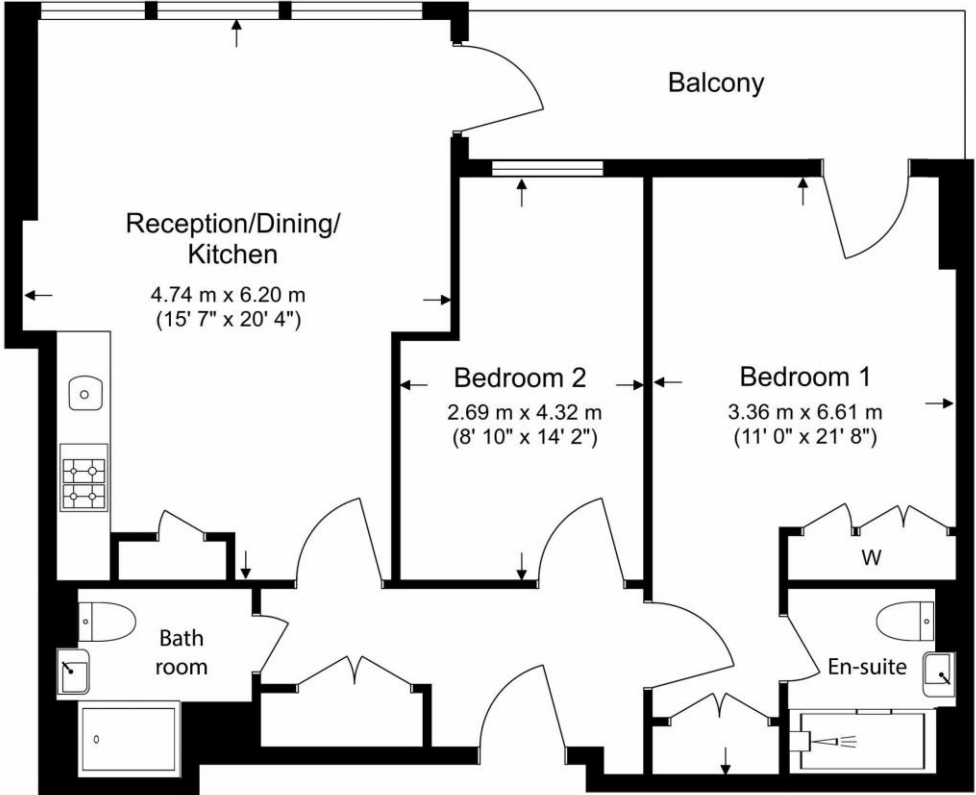

Score	Energy rating	Current	Potential
92+	A		
81-91	B		
69-80	C	79 C	79 C
55-68	D		
39-54	E		
21-38	F		
1-20	G		



Floor Plan measurements are approximate and are for illustrative purposes only. While we do not doubt the floor plans accuracy, we make no guarantee, warranty or representation as to the accuracy and completeness of the floor plan.

Terms & Conditions:

These particulars are for guidance purposes only and do not form part of an offer or contract.

Guide Price:	£500,000
Tenure:	Leasehold Expires 29/01/3000 Approximately 973 Years Remaining
Ground Rent:	£550.00 (per annum) to June 2026
Service Charge:	£3,850.00 (per annum) to June 2026
Anticipated Rent:	£2,400.00 pcm Approx. 5.8% Yield

Viewings:

All viewings are by appointment only through our Woolwich Office.

Our reference: WOO250017

T: 020 8051 0700

E: woolwich.sales@benhams.com

W: www.benhams.com

Disclaimer: These particulars are for guidance purposes only and do not form part of an offer or contract. Whilst care has been taken in their preparation, Benham and Reeves or the vendor shall not be held responsible for any inaccuracies. You should not rely on statements by Benham and Reeves Ltd in the particulars or by word of mouth or in writing as being factually accurate about the property, its condition or its value. Any areas, measurements or distances are approximate. The text, photographs and plans are for guidance only. The photographs appearing in these particulars show only certain parts of the property at the time when the photographs were taken. It should not be assumed that the property has all or any of the necessary planning permission, building regulation consent approval or other required consents for its previous, present or future intended usage. Any intending purchasers must satisfy themselves by inspection or by taking appropriate professional advice. Benham and Reeves Ltd has not rested any of the equipment, fittings or facilities.

London | Canary Wharf | City | Colindale | Dartmouth Park | Ealing | Fulham | Hampstead
Hammersmith | Highgate | Hyde Park | Kensington | Kew | Knightsbridge | Nine Elms
Surrey Quays | Shoreditch | Wembley | Wapping | White City | Woolwich

International | China | Hong Kong | India | Israel | Malaysia | Middle East | Pakistan
Singapore | South Africa | Turkey

