



## Fountain House, The Boulevard, Imperial Wharf, Fulham £850,000

🏠 2 Bedroom(s)   🚿 2 Bathroom(s)   🔑 Leasehold

**\*\* With River Views \*\*** A light fourth floor apartment spanning a generous 1066 square feet (approx.) This apartment chiefly comprises of a large open-plan reception area leading to a private balcony with river-facing views. Fully fitted kitchen with integrated appliances, master bedroom with dressing area and en-suite bathroom, second bedroom and second bathroom.

Imperial Wharf is a renowned...[Read more](#)

Visit

<https://www.benhams.com/property-for-sale/fountain-house-the-boulevard-sw6/19597290/>  
for full details

For more information about this property, please call our London Sales office on

**020 3280 6400**

London Sales Office  
2nd Floor, Harbour Exchange 5, Canary Wharf, London  
E14 9GE  
<https://www.benhams.com>



## Floor plan

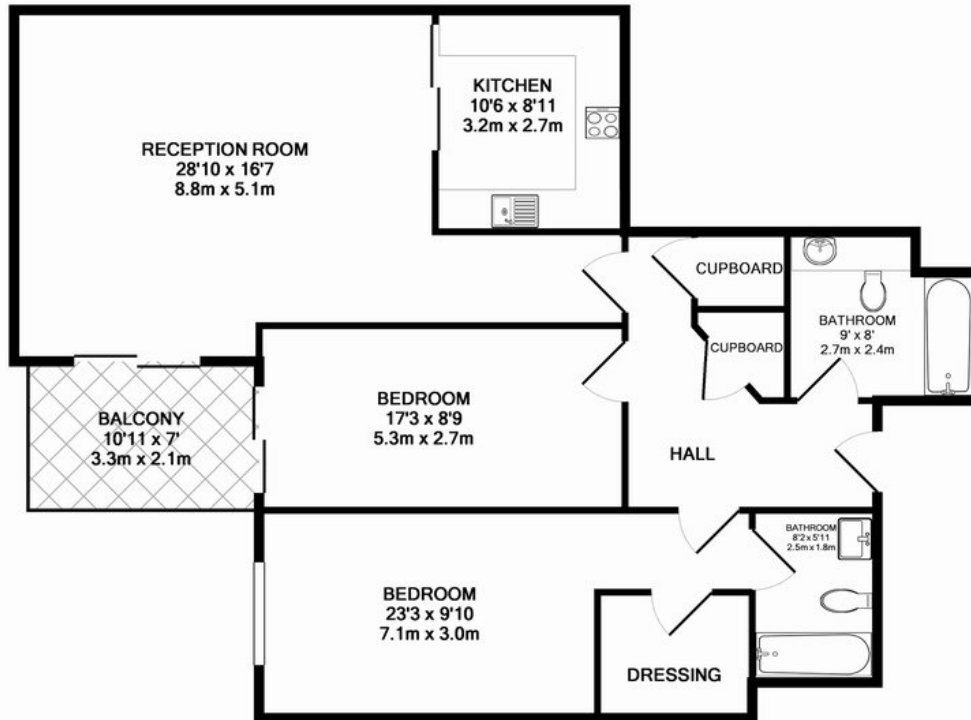

FOUNTAIN HOUSE - IMPERIAL WHARF  
TOTAL APPROX. FLOOR AREA 1066 SQ.FT. (99.0 SQ.M.)

Whilst every attempt has been made to ensure the accuracy of the floor plan contained here, measurements of doors, windows, rooms and any other items are approximate and no responsibility is taken for any error, omission, or mis-statement. This plan is for illustrative purposes only and should be used as such by any prospective purchaser. The services, systems and appliances shown have not been tested and no guarantee as to their operability or efficiency can be given  
Made with Metropix ©2014

## Energy performance certificates

Energy Efficiency Rating		
	Current	Potential
<i>Very energy efficient - lower running costs</i>		
(92-100) <b>A</b>		
(81-91) <b>B</b>		
(69-80) <b>C</b>	78	82
(55-68) <b>D</b>		
(39-54) <b>E</b>		
(21-38) <b>F</b>		
(1-20) <b>G</b>		
<i>Not energy efficient - higher running costs</i>		
<b>England, Scotland &amp; Wales</b>	EU Directive 2002/91/EC	

**Disclaimer:** these particulars are for guidance purposes only and do not form part of an offer or contract. Whilst care has been taken in their preparation, Benham and Reeves or the vendor shall not be held responsible for any inaccuracies. You should not rely on statements by Benham and Reeves Ltd in the particulars or by word of mouth or in writing as being factually accurate about the property, its condition or its value. Any areas, measurements or distances are approximate. The text, photographs and plans are for guidance only. The photographs appearing in these particulars show only certain parts of the property at the time when the photographs were taken. It should not be assumed that the property has all or any of the necessary planning permission, building regulation consent approval or other required consents for its previous, present or future intended usage. Any intending purchasers must satisfy themselves by inspection or by taking appropriate professional advice. Benham and Reeves Ltd has not tested any of the equipment, fittings or facilities.