



Benham & Reeves

Dickens Yard, Ealing, W5

£531 per week, £2,301 per month + fees

🛏️ 2 Bedrooms 🚿 1 Bathroom 🛋️ Furnished

A superb 2nd floor apartment, with good resident facilities, situated within a popular development in Ealing development. . The property is ideally located close to open spaces, shops, and Ealing Broadway (Circle and District lines) underground and Overground stations.

Please [click here](#) for full detail

Property features

2 Bedrooms | Bathroom | Reception | Furnished | Fitted Kitchen | EPC-B | 24hr Concierge | Swimming Pool & Gym | Nearby Ealing Broadway Station

For more information about this property,
please call our Ealing branch on

020 8280 0140

Redress & Client Money Protection :

Benham and Reeves are members of The Property Ombudsman redress scheme and have Client Money protection with ARLA Propertymark. You can find more information on our website at <https://www.benhamandreeves.com/membership/>



Benham & Reeves



Dickens Yard, Ealing, W5

£531 per week, £2,301 per month + fees

www.benhams.com

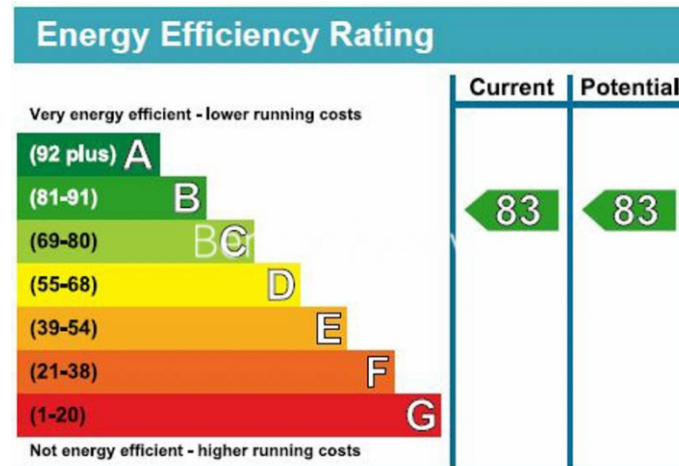
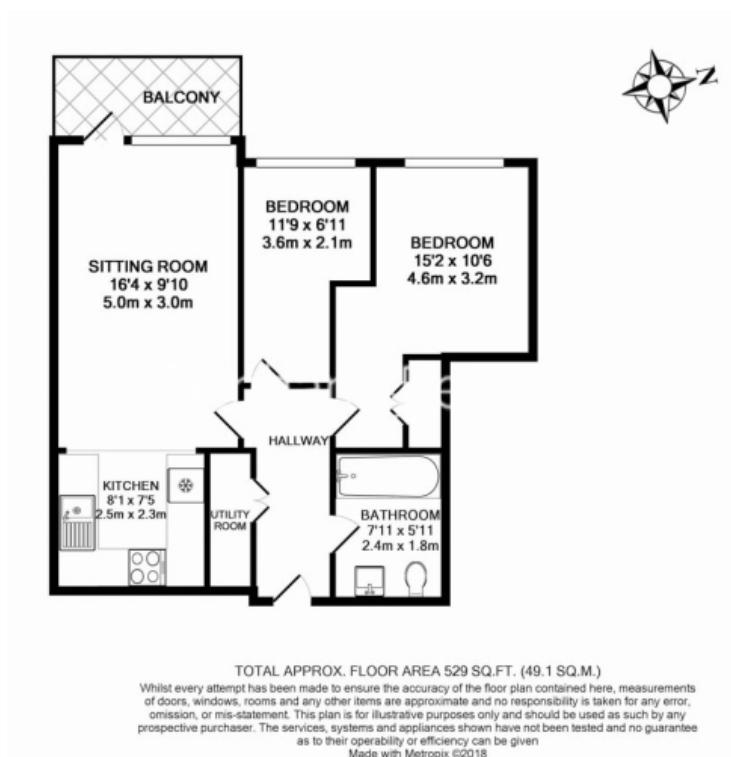

London branches open six days a week Mon - Sat

Canary Wharf | City | Colindale | Dartmouth Park | Ealing | Fulham
Hammersmith | Hampstead | Highgate | Hyde Park | Kensington | Kew
Knightsbridge | Nine Elms | Shoreditch | Southall | Surrey Quays
Wapping | Wembley | White City | Woolwich

International offices

China | Hong Kong SAR | India | Israel | Malaysia | Middle East | Pakistan
Qatar | Singapore | South Africa | Thailand | Turkey



Benham & Reeves