



Benham & Reeves

**East Acton Lane, Acton, W3**

£600 per week, £2,600 per month + fees

 2 Bedrooms    2 Bathrooms     
Furnished/UnFurnished

This brand-new 6th floor furnished apartment is situated within the latest phase of an exciting new development in Acton, close to fast transport connections. Perfectly located a short walk from East Acton station (Central Line).

Please [click here](#) for full detail

## Property features

**Brand New | Balcony | Furnished or Unfurnished | Large Open Plan Reception | Wood Floor | EPC-B | Large Windows | Fully Fitted Modern Kitchen | Close To Fast Transport Connections | Nearby East Acton Station (Central line)**

For more information about this property,  
please call our Ealing branch on

**020 8280 0140**

Redress & Client Money Protection :

Benham and Reeves are members of The Property Ombudsman redress scheme and have Client Money protection with ARLA Propertymark. You can find more information on our website at <https://www.benhamandreeves.com/membership/>



**Benham & Reeves**



# East Acton Lane, Acton, W3

£600 per week, £2,600 per month + fees

www.benhams.com

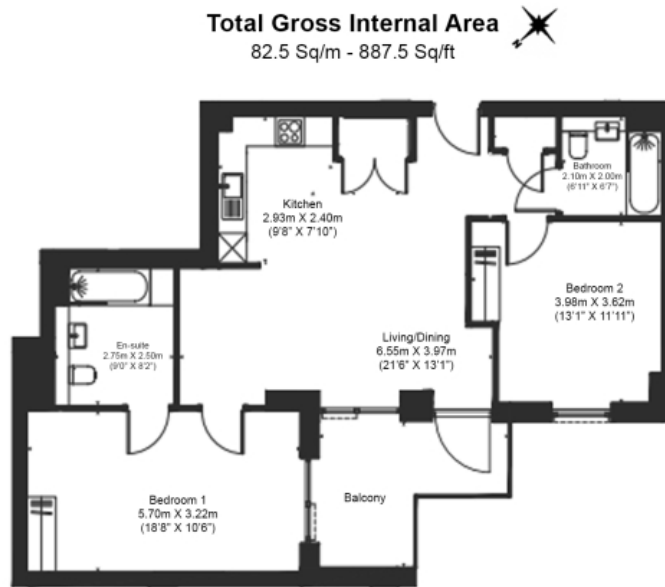

Floor Plan measurements are approximate and are for illustrative purposes only. While we do not doubt the floor plans accuracy, we make no guarantee, warranty or representation as to the accuracy and completeness of the floor plan.

Score	Energy rating	Current	Potential
92+	A		
81-91	B	85   B	85   B
69-80	C		
55-68	D		
39-54	E		
21-38	F		
1-20	G		

## London branches open six days a week Mon - Sat

Canary Wharf | City | Colindale | Dartmouth Park | Ealing | Fulham  
Hammersmith | Hampstead | Highgate | Hyde Park | Kensington | Kew  
Knightsbridge | Nine Elms | Shoreditch | Southall | Surrey Quays  
Wapping | Wembley | White City | Woolwich

## International offices

China | Hong Kong SAR | India | Israel | Malaysia | Middle East | Pakistan  
Qatar | Singapore | South Africa | Thailand | Turkey

