



Benham & Reeves

East Acton Lane, Acton, W3

£438 per week, £1,898 per month + fees

 1 Bedroom  1 Bathroom  Furnished

This furnished 10th floor apartment, naturally bright from large windows is part of an exciting development in Acton, a brief walk from East Acton Station (Central Line).

Please [click here](#) for full detail

Property features

Large Open Plan Reception | Balcony | Furnished | Wood Floor | Large Windows | EPC-B | Close To Fast Transport Connections | Fully Fitted Modern Kitchen | Short walk to East Acton Station (Central line)

For more information about this property, please call our Property Management branch on

020 7319 9740



Redress & Client Money Protection :

Benham and Reeves are members of The Property Ombudsman redress scheme and have Client Money protection with ARLA Propertymark. You can find more information on our website at <https://www.benham.com/membership/>

Benham & Reeves



East Acton Lane, Acton, W3

£438 per week, £1,898 per month + fees

www.benhams.com

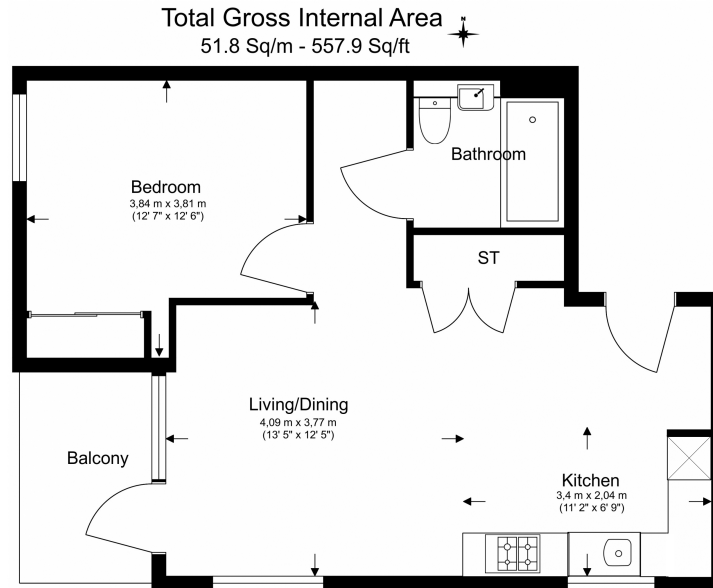

Floor Plan measurements are approximate and are for illustrative purposes only. While we do not doubt the floor plans accuracy, we make no guarantee, warranty or representation as to the accuracy and completeness of the floor plan.

Score	Energy rating	Current	Potential
92+	A		
81-91	B	83 B	83 B
69-80	C		
55-68	D		
39-54	E		
21-38	F		
1-20	G		

London branches open six days a week Mon - Sat

Canary Wharf | City | Colindale | Dartmouth Park | Ealing | Fulham
Hammersmith | Hampstead | Highgate | Hyde Park | Kensington | Kew
Knightsbridge | Nine Elms | Shoreditch | Southall | Surrey Quays
Wapping | Wembley | White City | Woolwich

International offices

China | Hong Kong SAR | India | Indonesia | Qatar | Malaysia | Middle East |
Singapore | South Africa | Thailand | Turkey



Benham & Reeves