



Benham & Reeves

Summerlands Avenue, Acton, W3

£461 per week, £1,998 per month + fees

 2 Bedrooms  2 Bathrooms  Unfurnished

A well-presented split level apartment set in a detached period conversion within a mile from Acton Central (overground) and Acton Main Line Station.

Please [click here](#) for full detail

Property features

2 Bedrooms | 2 Bathrooms | Spacious Reception | Fitted Kitchen With Appliances | Split level | EPC-C | Period property | Close to amenities | Nearby Acton Main Line stations

For more information about this property,
please call our Ealing branch on

020 8280 0140



Redress & Client Money Protection :
Benham and Reeves are members of The Property Ombudsman redress scheme and have Client Money protection with ARLA Propertymark.
You can find more information on our website at <https://www.benhamandreeves.com/membership/>

Benham&Reeves



Summerlands Avenue, Acton, W3

£461 per week, £1,998 per month + fees

www.benhams.com

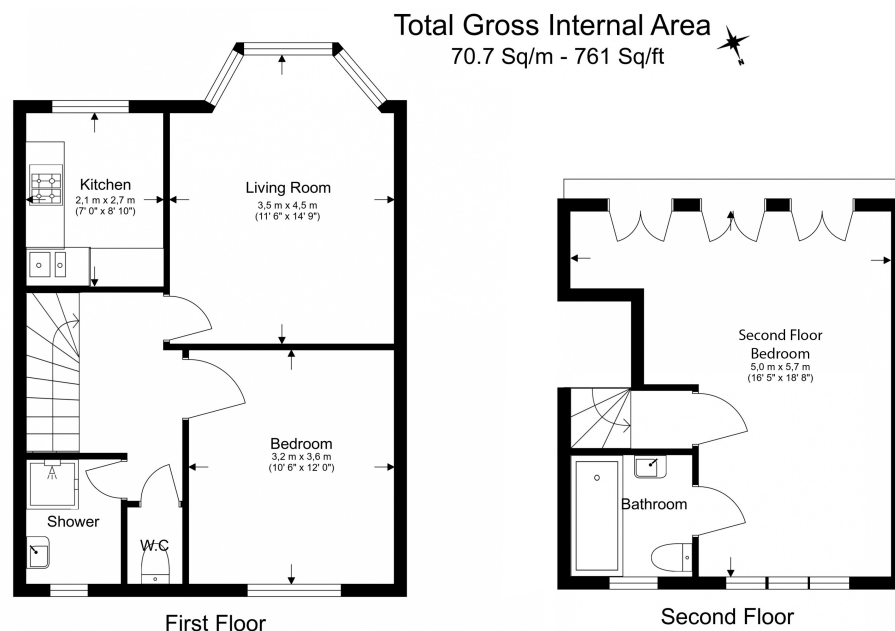

Floor Plan measurements are approximate and are for illustrative purposes only. While we do not doubt the floor plans accuracy, we make no guarantee, warranty or representation as to the accuracy and completeness of the floor plan.

Score	Energy rating	Current	Potential
92+	A		
81-91	B		
69-80	C	71 c	75 c
55-68	D		
39-54	E		
21-38	F		
1-20	G		

London branches open six days a week Mon - Sat

Canary Wharf | City | Colindale | Dartmouth Park | Ealing | Fulham
Hammersmith | Hampstead | Highgate | Hyde Park | Kensington | Kew
Knightsbridge | Nine Elms | Shoreditch | Southall | Surrey Quays
Wapping | Wembley | White City | Woolwich

International offices

China | Hong Kong SAR | India | Indonesia | Qatar | Malaysia | Middle East |
Singapore | South Africa | Thailand | Turkey



Benham & Reeves