



Benham & Reeves

Commercial Street, Aldgate, E1

£850 per week, £3,683 per month + fees

 2 Bedrooms  1 Bathroom  Furnished

Smart apartment situated within a modern development in Aldgate, moments from the tube and within a short walk of The City, Spitalfields and Shoreditch

Please [click here](#) for full detail

Property features

Spacious Two Bedroom, One Bathroom Apartment | Reception With Balcony | Open Plan Kitchen With Integrated Appliances | Two Well Equipped Bedrooms | Bespoke Bathroom | EPC-B | Residents Gym, Roof Terrace & 24hr Concierge | Underfloor Heating, Air Cooling, Light Settings | Short Walk To The City, Spitalfields & Shoreditch | Minutes To Aldgate East Station (District, Hammersmith, City)

For more information about this property, please call our Wapping branch on

020 7680 8900

Redress & Client Money Protection :

Benham and Reeves are members of The Property Ombudsman redress scheme and have Client Money protection with ARLA Propertymark. You can find more information on our website at <https://www.benhams.com/membership/>



Benham & Reeves



Commercial Street, Aldgate, E1

£850 per week, £3,683 per month + fees

www.benhams.com

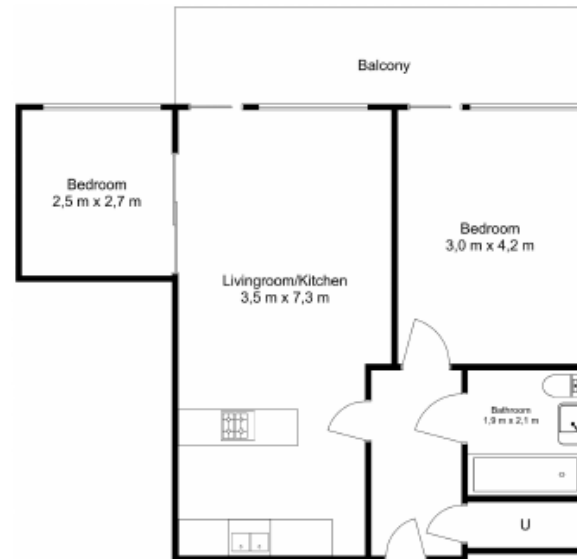

Total - 748 sq.ft - 69.5 sq.m

Floor Plan measurements are approximate and are for illustrative purposes only. While we do not doubt the floor plans accuracy, we make no guarantee, warranty or representation as to the accuracy and completeness of the floor plan.

Energy Efficiency Rating

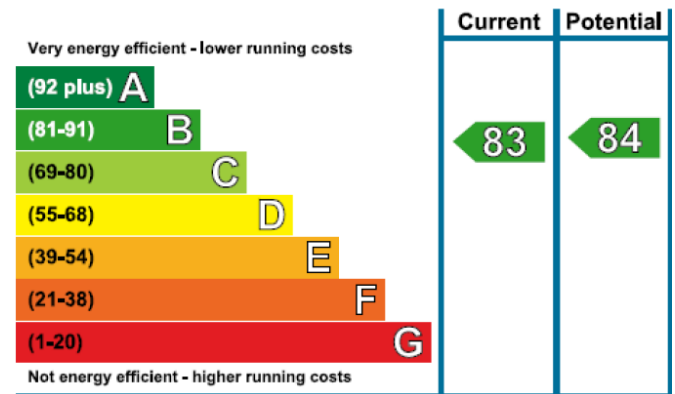

London branches open six days a week Mon - Sat

Canary Wharf | City | Colindale | Dartmouth Park | Ealing | Fulham
Hammersmith | Hampstead | Highgate | Hyde Park | Kensington | Kew
Knightsbridge | Nine Elms | Shoreditch | Southall | Surrey Quays
Wapping | Wembley | White City | Woolwich



International offices

China | Hong Kong SAR | India | Indonesia | Israel | Malaysia | Middle East | Pakistan
Qatar | Singapore | South Africa | Thailand | Turkey

Benham & Reeves