



Benham & Reeves

Fladgate House, Battersea, SW11

£1,038 per week, £4,500 per month + fees

 2 Bedrooms  2 Bathrooms  Furnished

A stunning large 13th floor apartment with views of the Power Station, situated in an extremely popular development on the River. The Battersea Power Station Tube is located onsite (Northern Line).

Please [click here](#) for full detail

Property features

Two double bedrooms | Two bathrooms | Balcony | Direct views of Battersea Power Station | Air cooling | EPC-B | 24 Hour concierge | Swimming pool | Gym | Battersea Power Station tube

For more information about this property,
please call our Nine Elms branch on

020 3282 3700

Redress & Client Money Protection :

Benham and Reeves are members of The Property Ombudsman redress scheme and have Client Money protection with ARLA Propertymark. You can find more information on our website at <https://www.benhams.com/membership/>



Benham & Reeves

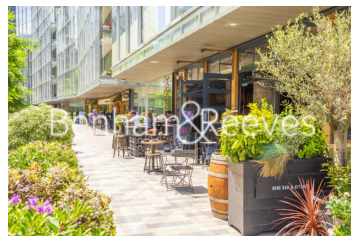

Fladgate House, Battersea, SW11

£1,038 per week, £4,500 per month + fees

www.benhams.com

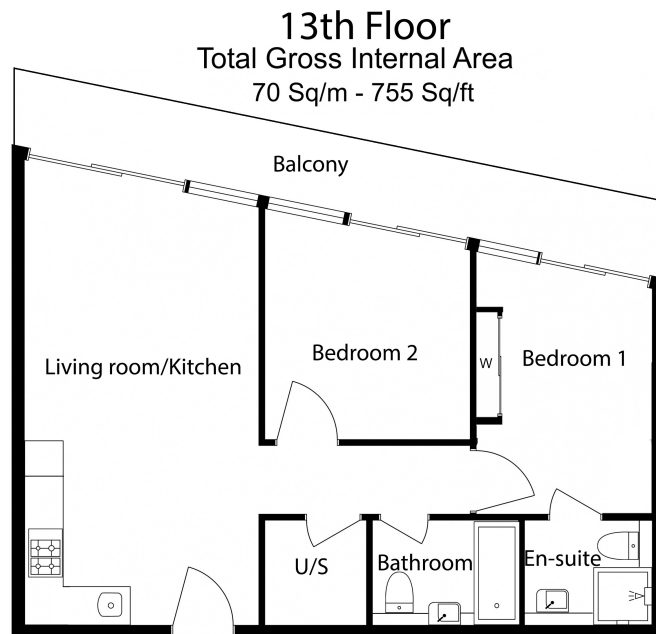

Benham & Reeves

Floor Plan measurements are approximate and are for illustrative purposes only. While we do not doubt the floor plans accuracy, we make no guarantee, warranty or representation as to the accuracy and completeness of the floor plan.

Energy Efficiency Rating		
	Current	Potential
Very energy efficient - lower running costs		
(92-100) A		
(81-91) B		
(69-80) C	76	76
(55-68) D		
(39-54) E		
(21-38) F		
(1-20) G		
Not energy efficient - higher running costs		
England & Wales		EU Directive 2002/91/EC

London branches open six days a week Mon - Sat

Canary Wharf | City | Colindale | Dartmouth Park | Ealing | Fulham
Hammersmith | Hampstead | Highgate | Hyde Park | Kensington | Kew
Knightsbridge | Nine Elms | Shoreditch | Southall | Surrey Quays
Wapping | Wembley | White City | Woolwich

International offices

China | Hong Kong SAR | India | Indonesia | Qatar | Malaysia | Middle East |
Singapore | South Africa | Thailand | Turkey



Benham & Reeves