



Benham & Reeves

Tanner Street, Bermondsey, SE1

£565 per week, £2,448 per month + fees

 1 Bedroom  1 Bathroom  Furnished

Well maintained one bedroom duplex apartment set within a purpose-built residential development on Tanner Street. Located within moments of Bermondsey Street. The property is also within a short walk of London Bridge station and into The City.

Please [click here](#) for full detail

Property features

Furnished Duplex Apartment | Wood Floors To All Living Areas & Large Windows Throughout | Bright Open Plan Reception With Private Balcony | Separate Fitted Kitchen With Fully Integrated Appliances | Spacious Bedroom With Large Mirrored Fitted Wardrobe | EPC-B | Bespoke Bathroom With Mirrored Vanity Cabinets & Dual Access | Concierge & On-Site Parking Available* (subject to separate) | Walking Distance Into The City & Easy Reach Of Canary Wharf | Short Walk To London Bridge Station

For more information about this property,
please call our Wapping branch on

020 7680 8900

Redress & Client Money Protection :

Benham and Reeves are members of The Property Ombudsman redress scheme and have Client Money protection with ARLA Propertymark. You can find more information on our website at <https://www.benhams.com/membership/>



Benham & Reeves



Tanner Street, Bermondsey, SE1

£565 per week, £2,448 per month + fees

www.benhams.com

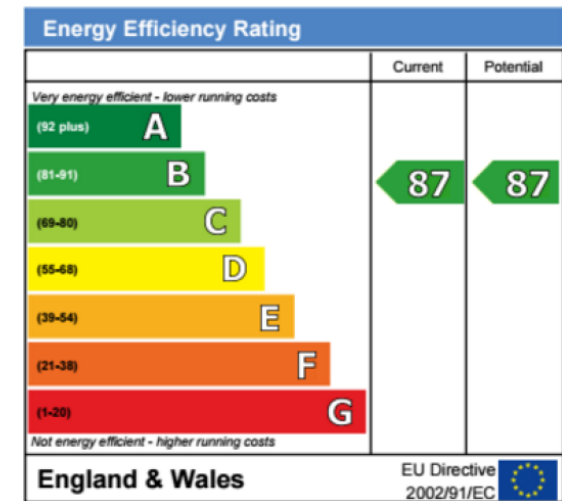
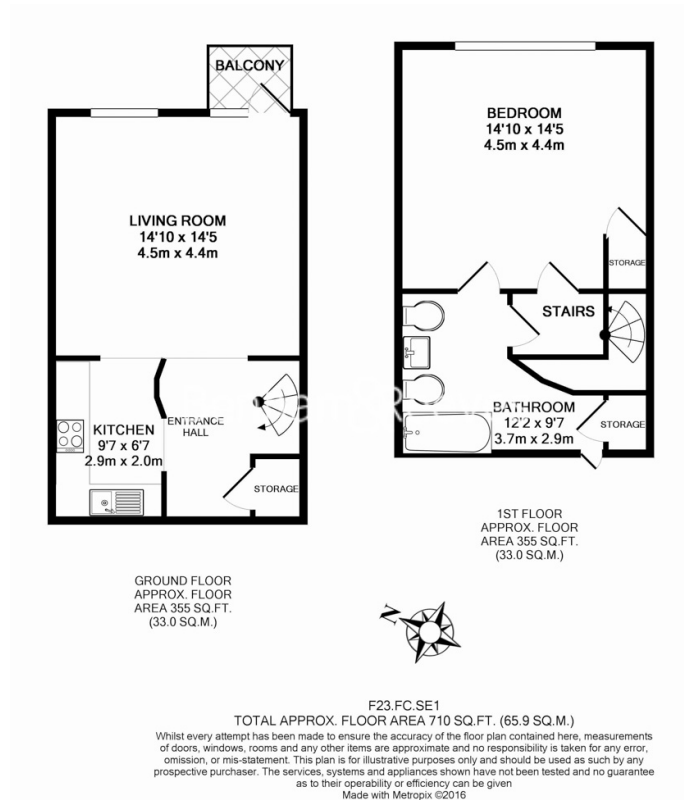

London branches open six days a week Mon - Sat

Canary Wharf | City | Colindale | Dartmouth Park | Ealing | Fulham
Hammersmith | Hampstead | Highgate | Hyde Park | Kensington | Kew
Knightsbridge | Nine Elms | Shoreditch | Southall | Surrey Quays
Wapping | Wembley | White City | Woolwich

International offices

China | Hong Kong SAR | India | Indonesia | Qatar | Malaysia | Middle East |
Singapore | South Africa | Thailand | Turkey



Benham & Reeves