



Benham & Reeves

Bevan House, Boswell Street, WC1N

£739 per week, £3,202 per month + fees

🛏️ 2 Bedrooms 🚿 1 Bathroom 🛋️ Furnished

Conveniently located apartment set in a purpose build development a short walk from Holborn and Russell Square Station, suitable for students.

Please [click here](#) for full detail

Property features

Two Bedroom Apartment | Family Size Bathroom | Open Plan Living Space | Fitted Kitchen | Furnished | EPC-C | Close to Amenities | Excellent Transport Links | Holborn & Russell Square Stations Nearby

For more information about this property,
please call our City branch on

020 7213 9700

Redress & Client Money Protection :

Benham and Reeves are members of The Property Ombudsman redress scheme and have Client Money protection with ARLA Propertymark. You can find more information on our website at <https://www.benhamandreeves.com/membership/>



Benham&Reeves



Bevan House, Boswell Street, WC1N

£739 per week, £3,202 per month + fees

www.benhams.com

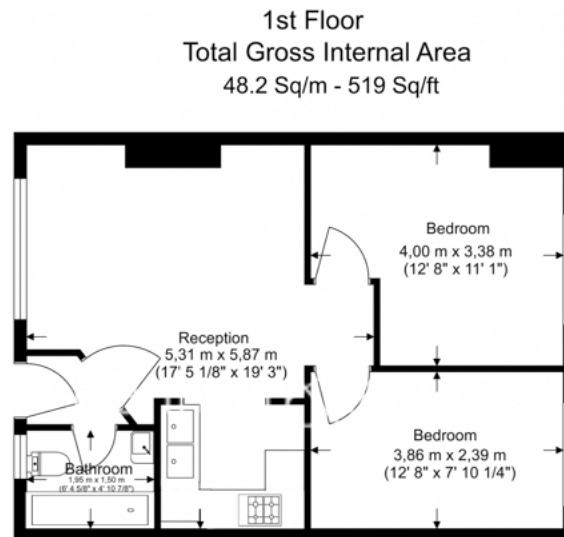

Floor Plan measurements are approximate and are for illustrative purposes only. While we do not doubt the floor plans accuracy, we make no guarantee, warranty or representation as to the accuracy and completeness of the floor plan.

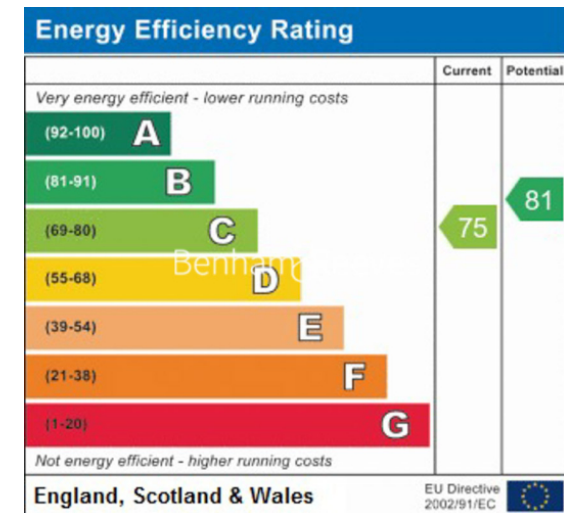

London branches open six days a week Mon - Sat

Canary Wharf | City | Colindale | Dartmouth Park | Ealing | Fulham
Hammersmith | Hampstead | Highgate | Hyde Park | Kensington | Kew
Knightsbridge | Nine Elms | Shoreditch | Southall | Surrey Quays
Wapping | Wembley | White City | Woolwich

International offices

China | Hong Kong SAR | India | Indonesia | Qatar | Malaysia | Middle East | Pakistan
Singapore | South Africa | Thailand | Turkey



Benham & Reeves