



Benham & Reeves

Kew Bridge Road, Brentford, TW8

£647 per week, £2,804 per month + fees

 2 Bedrooms  2 Bathrooms  Unfurnished

Modern large apartment, with secure underground parking, situated in a popular riverside development, with a host of on-site facilities, close to the amenities of Kew. Located within walking distance from Kew Bridge National Rail station, which offers direct services to Waterloo in half an hour. Drivers benefit from easy access to the A4/M4.

Please [click here](#) for full detail

Property features

24 hours concierge | Underground parking | Wood floors | Wine Cooler | River Views And Two Private Balconies | EPC-B | Integrated Speaker System | Resident's gym | Underfloor Heating And Air Conditioning | Kew bridge station

For more information about this property,
please call our Kew branch on

020 8326 1960

Redress & Client Money Protection :

Benham and Reeves are members of The Property Ombudsman redress scheme and have Client Money protection with ARLA Propertymark. You can find more information on our website at <https://www.benhamandreeves.com/membership/>



Benham & Reeves



Kew Bridge Road, Brentford, TW8

£647 per week, £2,804 per month + fees

www.benhams.com

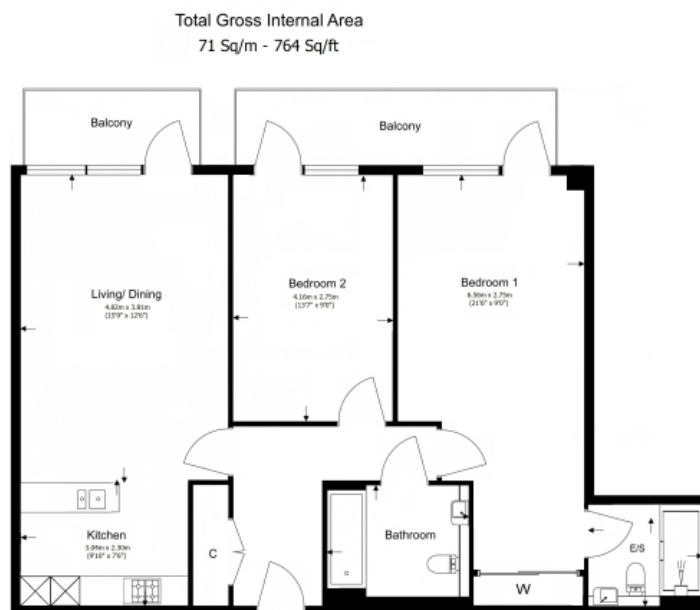

Floor Plan measurements are approximate and are for illustrative purposes only. While we do not doubt the floor plans accuracy we make no guarantee, warranty or representation as to the accuracy and completeness of the floor plan.

Score	Energy rating	Current	Potential
92+	A		
81-91	B	82 B	84 B
69-80	C		
55-68	D		
39-54	E		
21-38	F		
1-20	G		

London branches open six days a week Mon - Sat

Canary Wharf | City | Colindale | Dartmouth Park | Ealing | Fulham
Hammersmith | Hampstead | Highgate | Hyde Park | Kensington | Kew
Knightsbridge | Nine Elms | Shoreditch | Southall | Surrey Quays
Wapping | Wembley | White City | Woolwich

International offices

China | Hong Kong SAR | India | Indonesia | Qatar | Malaysia | Middle East | Pakistan
Singapore | South Africa | Thailand | Turkey



Benham & Reeves