



Benham & Reeves

Pan Peninsula Square, Canary Wharf, E14

£739 per week, £3,202 per month + fees

 2 Bedrooms  2 Bathrooms  Furnished

Modern 28th floor apartment, with stunning views and 5* Health Club, situated in a modern popular development within walking distance of Canary Wharf and the City with excellent transport links.

Please [click here](#) for full detail

Property features

2 Bedrooms | 2 Bathrooms | Open Planned Reception | Furnished | Fitted Kitchen | EPC-B | 24 hour concierge | Close To Amenities | Nearby South Quay DLR

For more information about this property, please call our Canary Wharf branch on

020 8036 3200

Redress & Client Money Protection :

Benham and Reeves are members of The Property Ombudsman redress scheme and have Client Money protection with ARLA Propertymark. You can find more information on our website at <https://www.benhamandreeves.com/membership/>



Benham & Reeves



Pan Peninsula Square, Canary Wharf, E14

£739 per week, £3,202 per month + fees

www.benhams.com

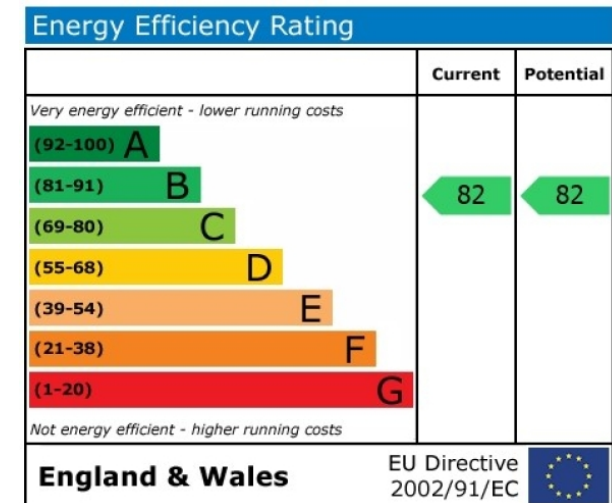
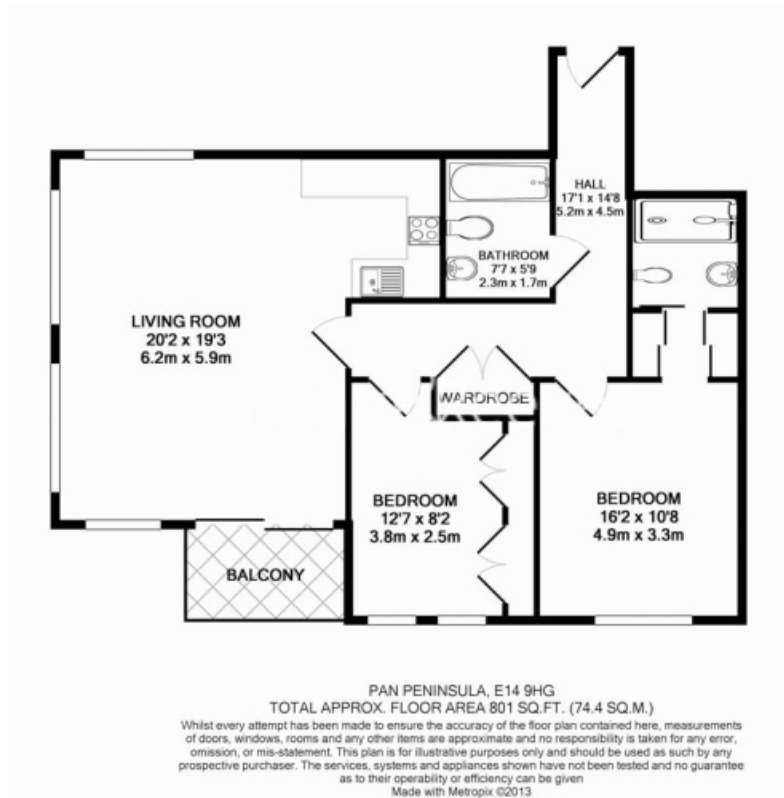

London branches open six days a week Mon - Sat

Canary Wharf | City | Colindale | Dartmouth Park | Ealing | Fulham
Hammersmith | Hampstead | Highgate | Hyde Park | Kensington | Kew
Knightsbridge | Nine Elms | Shoreditch | Southall | Surrey Quays
Wapping | Wembley | White City | Woolwich

International offices

China | Hong Kong SAR | India | Indonesia | Qatar | Malaysia | Middle East | Pakistan
Singapore | South Africa | Thailand | Turkey



Benham & Reeves