



Benham & Reeves

Hawser Lane, Canary Wharf, E14

£485 per week, £2,102 per month + fees

 1 Bedroom  1 Bathroom  Furnished

Brand new, exquisite, furnished apartment set in a stunning, sought after development with access to a beautifully landscaped 2.5-acre Riverside park, located on the banks of the River Lea, 1.7 miles from Canary Wharf.

Please [click here](#) for full detail

Property features

BRAND NEW | Triple Glazed Windows | LARGE open plan RECEPTION with Floor to CEILING Windows | Fitted Kitchen, Including Dishwasher | Private Balcony | EPC-B | High Energy Rate Efficiency | 24-hour Concierge | Under Floor Heating | Canning Town Underground Station

For more information about this property, please call our Canary Wharf branch on

020 8036 3200

Redress & Client Money Protection :

Benham and Reeves are members of The Property Ombudsman redress scheme and have Client Money protection with ARLA Propertymark. You can find more information on our website at <https://www.benhams.com/membership/>



Benham & Reeves



Hawser Lane, Canary Wharf, E14

£485 per week, £2,102 per month + fees

www.benhams.com

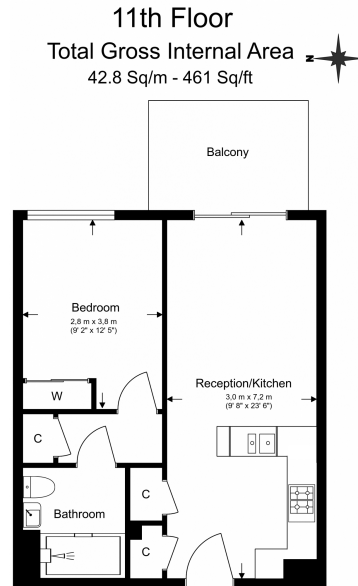

Floor Plan measurements are approximate and are for illustrative purposes only. While we do not doubt the floor plans accuracy, we make no guarantee, warranty or representation as to the accuracy and completeness of the floor plan.

Score	Energy rating	Current	Potential
92+	A		
81-91	B	83 B	83 B
69-80	C		
55-68	D		
39-54	E		
21-38	F		
1-20	G		

London branches open six days a week Mon - Sat

Canary Wharf | City | Colindale | Dartmouth Park | Ealing | Fulham
Hammersmith | Hampstead | Highgate | Hyde Park | Kensington | Kew
Knightsbridge | Nine Elms | Shoreditch | Southall | Surrey Quays
Wapping | Wembley | White City | Woolwich

International offices

China | Hong Kong SAR | India | Indonesia | Qatar | Malaysia | Middle East |
Singapore | South Africa | Thailand | Turkey

