



Benham & Reeves

## **Marsh Wall, Canary Wharf, E14**

£923 per week, £4,000 per month + fees

 2 Bedrooms    2 Bathrooms    Furnished

Luxurious two-bedroom apartment situated within desirable development with Stunning Amenities, a short distance to buses and DLR (South Quay) and 10 minutes to underground (Canary Wharf) providing excellent travel connections across the capital.

Please [click here](#) for full detail

## Property features

**Two Double Bedroom | Two Bathroom | Open Planned Living | Fitted Kitchen | Modern Kitchen with Integrated Appliances - Including Dishwa | EPC-B | Benefits from 24 hour Concierge and Residents Gym | Sate of the art Furnishing | Walking distance to Canary wharf | Nearby DLR South Quay Plaza station**

For more information about this property,  
please call our Canary Wharf branch on

**020 8036 3200**

Redress & Client Money Protection :

Benham and Reeves are members of The Property Ombudsman redress scheme and have Client Money protection with ARLA Propertymark. You can find more information on our website at <https://www.benhamandreeves.com/membership/>



Benham & Reeves





# Marsh Wall, Canary Wharf, E14

£923 per week, £4,000 per month + fees

[www.benhams.com](http://www.benhams.com)

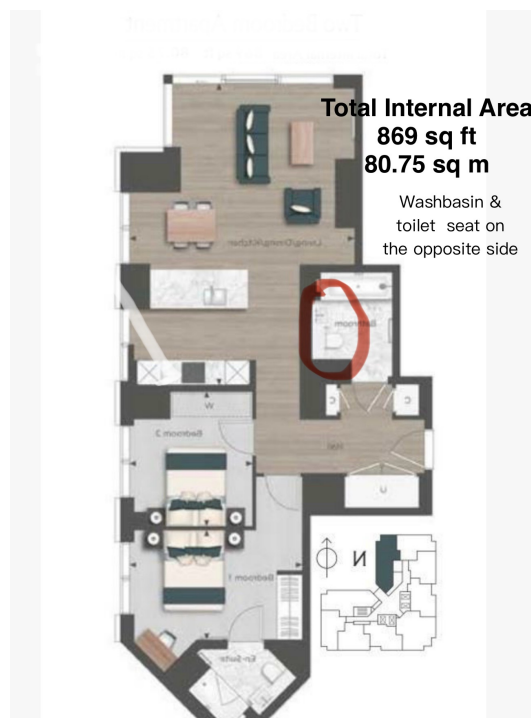

Score	Energy rating	Current	Potential
92+	A		
81-91	B	82 B	82 B
69-80	C		
55-68	D		
39-54	E		
21-38	F		
1-20	G		

## London branches open six days a week Mon - Sat

Canary Wharf | City | Colindale | Dartmouth Park | Ealing | Fulham  
Hammersmith | Hampstead | Highgate | Hyde Park | Kensington | Kew  
Knightsbridge | Nine Elms | Shoreditch | Southall | Surrey Quays  
Wapping | Wembley | White City | Woolwich

## International offices

China | Hong Kong SAR | India | Indonesia | Qatar | Malaysia | Middle East | Pakistan  
Singapore | South Africa | Thailand | Turkey

