



Benham & Reeves

**Yabsley Street, Canary Wharf, E14**

£808 per week, £3,500 per month + fees

🛏️ 3 Bedrooms    🚿 2 Bathrooms    🛋️ Furnished

Modern spacious apartment, with direct views of The River Thames, perfectly positioned for the hustle and bustle of Canary Wharf and The City. Located within walking distance of Blackwall DLR station.

Please [click here](#) for full detail

## Property features

**Three Good Size Double Bedrooms | Two Bathrooms | Bright Open Planned Living | Modern Furnishing | Fitted Kitchen | EPC-B | Balcony | Views of Canary Wharf | Residence Gym | Nearby Blackwall DLR Station**

For more information about this property,  
please call our Canary Wharf branch on

**020 8036 3200**

Redress & Client Money Protection :

Benham and Reeves are members of The Property Ombudsman redress scheme and have Client Money protection with ARLA Propertymark. You can find more information on our website at <https://www.benhamandreeves.com/membership/>



Benham & Reeves



# Yabsley Street, Canary Wharf, E14

£808 per week, £3,500 per month + fees

www.benhams.com

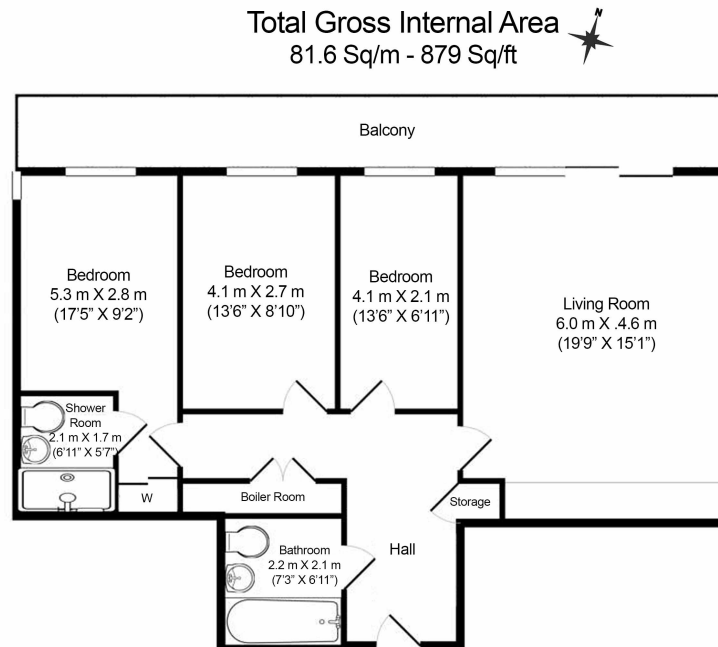

Benham & Reeves

Floor Plan measurements are approximate and are for illustrative purposes only. While we do not doubt the floor plans accuracy, we make no guarantee, warranty or representation as to the accuracy and completeness of the floor plan.

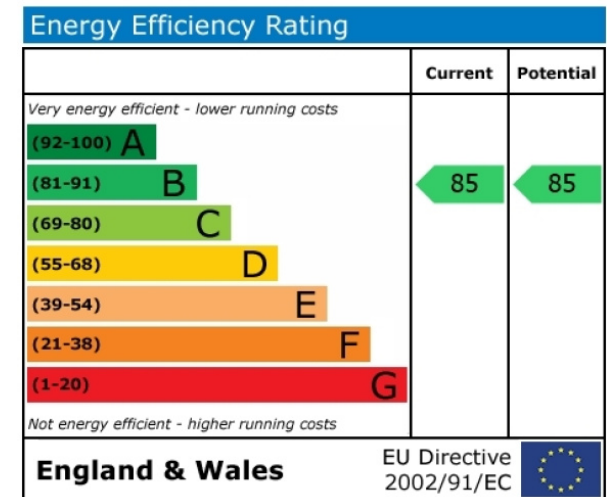

## London branches open six days a week Mon - Sat

Canary Wharf | City | Colindale | Dartmouth Park | Ealing | Fulham  
Hammersmith | Hampstead | Highgate | Hyde Park | Kensington | Kew  
Knightsbridge | Nine Elms | Shoreditch | Southall | Surrey Quays  
Wapping | Wembley | White City | Woolwich

## International offices

China | Hong Kong SAR | India | Indonesia | Qatar | Malaysia | Middle East | Pakistan  
Singapore | South Africa | Thailand | Turkey



Benham & Reeves