



Benham&Reeves

**One Thames City, Carnation way, SW8**

£1,500 per week, £6,500 per month + fees

 3 Bedrooms    2 Bathrooms    Furnished

A three-bedroom apartment furnished to a high standard and located on the 36th floor at the sought after One Thames City.

Please [click here](#) for full detail

## Property features

**Furnished | Three bedrooms | Two bathrooms | 36 th floor | Air cooling | EPC-B | 24 hour concierge | Swimming pool | Gym | Nine Elms and Vauxhall station**

For more information about this property,  
please call our Nine Elms branch on

**020 3282 3700**

Redress & Client Money Protection :

Benham and Reeves are members of The Property Ombudsman redress scheme and have Client Money protection with ARLA Propertymark. You can find more information on our website at <https://www.benham.com/membership/>



**Benham & Reeves**



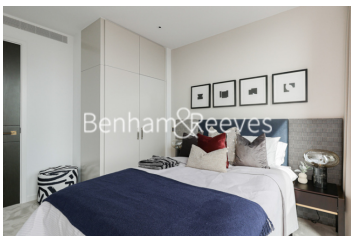
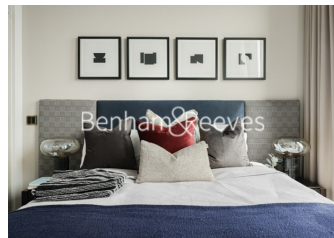

# One Thames City, Carnation way, SW8

£1,500 per week, £6,500 per month + fees

www.benhams.com

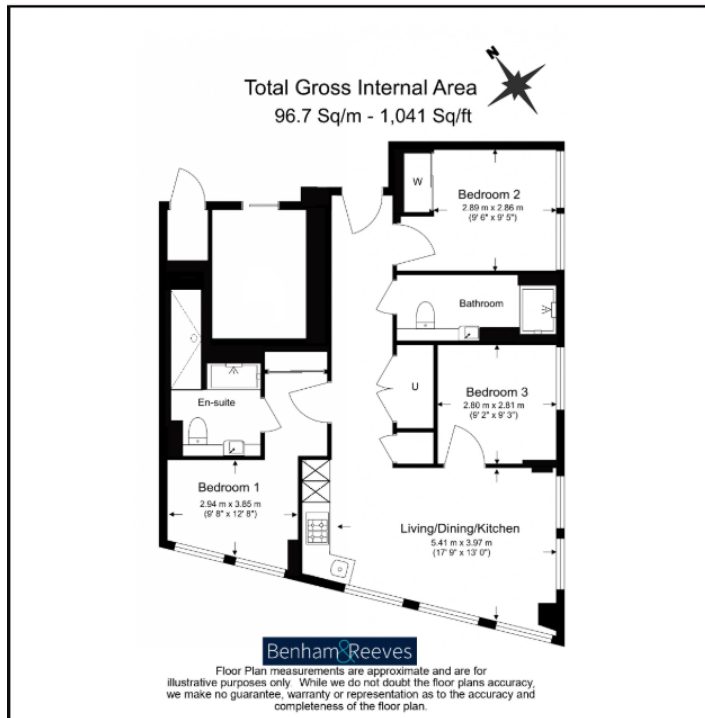

Score	Energy rating	Current	Potential
92+	A		
81-91	B	84 B	84 B
69-80	C		
55-68	D		
39-54	E		
21-38	F		
1-20	G		

## London branches open six days a week Mon - Sat

Canary Wharf | City | Colindale | Dartmouth Park | Ealing | Fulham  
Hammersmith | Hampstead | Highgate | Hyde Park | Kensington | Kew  
Knightsbridge | Nine Elms | Shoreditch | Southall | Surrey Quays  
Wapping | Wembley | White City | Woolwich

## International offices

China | Hong Kong SAR | India | Indonesia | Qatar | Malaysia | Middle East | Pakistan  
Singapore | South Africa | Thailand | Turkey



Benham & Reeves