



Benham & Reeves

Drayton Gardens, Chelsea SW10

£495 per week, £2,145 per month + fees

🛏 Studio 🚿 1 Bathroom 🛋 Furnished

A lovely 436 sq ft STUDIO on the 4th floor of the well-maintained DONOVAN COURT in Chelsea's Drayton Gardens. This light & airy apartment is smartly-presented and close to wonderful shops, restaurants, bars & lifestyle amenities. HEATING & HOT WATER included.

Please [click here](#) for full detail

Property features

Studio | Bathroom | Open Plan Fitted Kitchen | Furnished | Wood Flooring | EPC-D | 436 sq ft | Lift | Hot Water & Heating Included | Fulham Broadway, South Kensington & Earls Court Stations

For more information about this property, please call our Knightsbridge branch on

020 7581 2112



Drayton Gardens, Chelsea SW10

£495 per week, £2,145 per month + fees

www.benhams.com

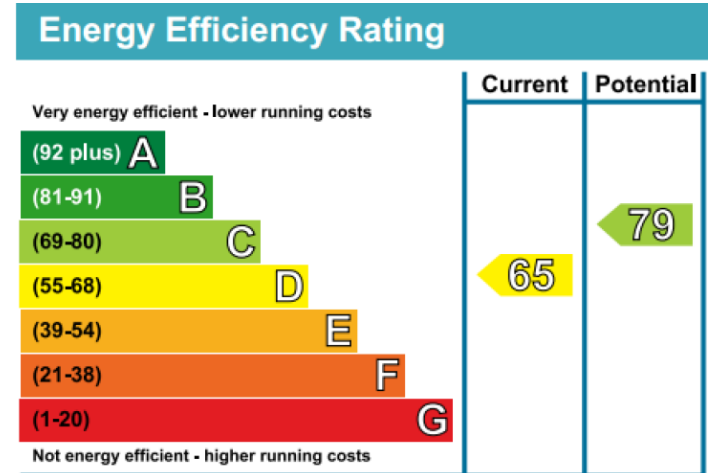
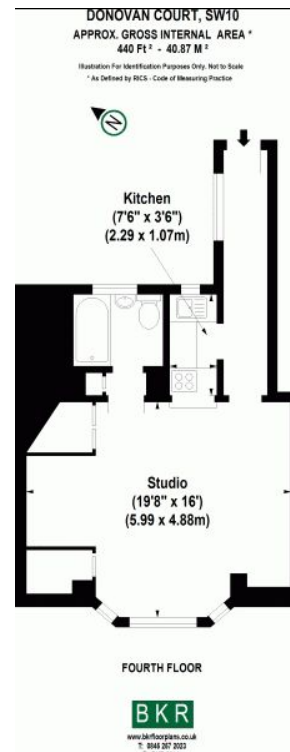

London branches open six days a week Mon - Sat

Canary Wharf | City | Colindale | Dartmouth Park | Ealing | Fulham
Hammersmith | Hampstead | Highgate | Hyde Park | Kensington | Kew
Knightsbridge | Nine Elms | Shoreditch | Southall | Surrey Quays
Wapping | Wembley | White City | Woolwich

International offices

China | Hong Kong SAR | India | Indonesia | Qatar | Malaysia | Middle East | Pakistan
Singapore | South Africa | Thailand | Turkey



Benham & Reeves