



Benham & Reeves

**Fetter Lane, City, EC4A**

£800 per week, £3,467 per month + fees

 1 Bedroom    1 Bathroom    Furnished

Modern apartment set in a luxury development that enjoys wonderful, landscaped gardens. Ideally located close (0.2 miles) to Chancery Lane Station (Central Line).

Please [click here](#) for full detail

## Property features

**One Bedroom With Built In Wardrobe | Reception Area With Juliet Balcony | Fitted Kitchen With Integrated Appliances | Bespoke Shower Wet Room | Contemporary Interior Design | EPC-B | Wood Floors & Floor To Ceiling Windows | Underfloor Heating & Integrated Comfort Cooling | City Of London Location | Close To Chancery Lane Station (Central Line)**

For more information about this property,  
please call our City branch on

**020 7213 9700**

Redress & Client Money Protection :

Benham and Reeves are members of The Property Ombudsman redress scheme and have Client Money protection with ARLA Propertymark. You can find more information on our website at <https://www.benhamandreeves.com/membership/>



**Benham & Reeves**



# Fetter Lane, City, EC4A

£800 per week, £3,467 per month + fees

[www.benhams.com](http://www.benhams.com)

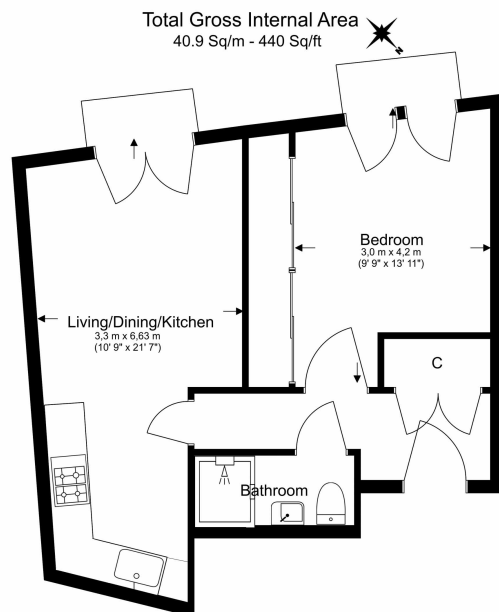

Floor Plan measurements are approximate and are for illustrative purposes only. While we do not doubt the floor plans accuracy, we make no guarantee, warranty or representation as to the accuracy and completeness of the floor plan.

Score	Energy rating	Current	Potential
92+	A		
81-91	B	82   B	82   B
69-80	C		
55-68	D		
39-54	E		
21-38	F		
1-20	G		

## London branches open six days a week Mon - Sat

Canary Wharf | City | Colindale | Dartmouth Park | Ealing | Fulham  
Hammersmith | Hampstead | Highgate | Hyde Park | Kensington | Kew  
Knightsbridge | Nine Elms | Shoreditch | Southall | Surrey Quays  
Wapping | Wembley | White City | Woolwich

## International offices

China | Hong Kong SAR | India | Indonesia | Qatar | Malaysia | Middle East | Pakistan  
Singapore | South Africa | Thailand | Turkey



Benham & Reeves