



Benham & Reeves

## **Canaletto Tower, City Road, EC1V**

£808 per week, £3,501 per month + fees

 1 Bedroom    1 Bathroom    Furnished

Luxury 1st floor apartment set within a highly prestigious development with impressive views of the London Skyline and a private residents' club, with roof garden on the 24th floor. Nearby transport options include Old Street Tube (Northern Line) and National Rail stations. EPC-B

Please [click here](#) for full detail

## Property features

**Luxury apartment | Large bedroom with fitted wardrobe | Bright spacious reception | Open plan kitchen | Full length private balcony with superb views | EPC-B | Close to borough, london bridge & easy reach of the city | Wood floors & floor to ceiling windows | Residents pool, gym, roof terrace & concierge | Old Street Tube (Northern Line) and National Rail stations.**

For more information about this property,  
please call our City branch on

**020 7213 9700**

Redress & Client Money Protection :

Benham and Reeves are members of The Property Ombudsman redress scheme and have Client Money protection with ARLA Propertymark. You can find more information on our website at <https://www.benhams.com/membership/>



Benham&Reeves



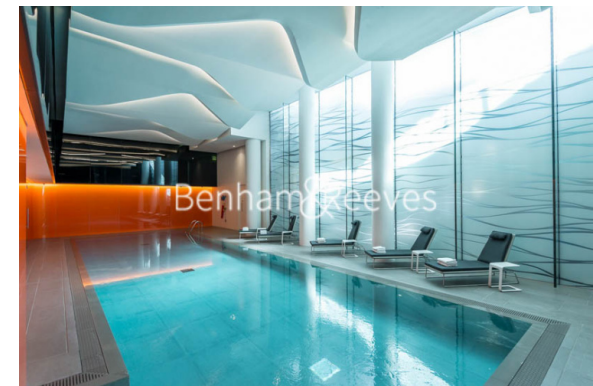

# Canaletto Tower, City Road, EC1V

£808 per week, £3,501 per month + fees

www.benhams.com

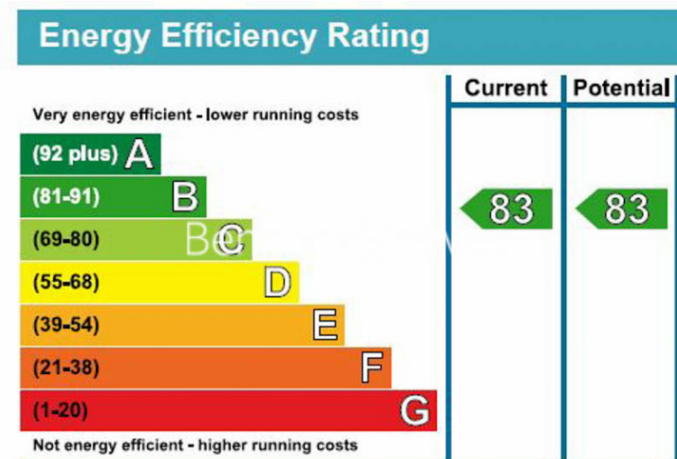
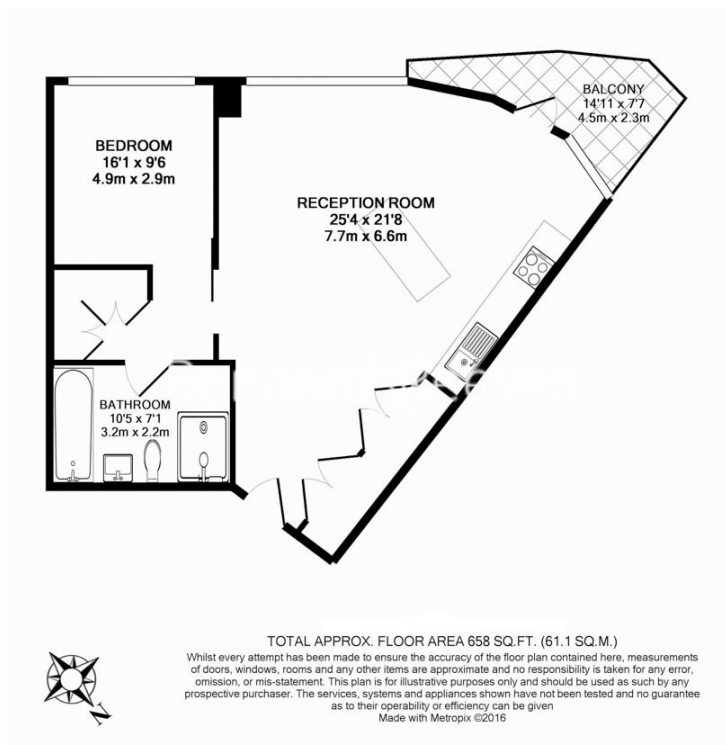

## London branches open six days a week Mon - Sat

Canary Wharf | City | Colindale | Dartmouth Park | Ealing | Fulham  
Hammersmith | Hampstead | Highgate | Hyde Park | Kensington | Kew  
Knightsbridge | Nine Elms | Shoreditch | Southall | Surrey Quays  
Wapping | Wembley | White City | Woolwich

## International offices

China | Hong Kong SAR | India | Indonesia | Qatar | Malaysia | Middle East |  
Singapore | South Africa | Thailand | Turkey



Benham & Reeves