



Benham & Reeves

Blackfriars Road, City, SE1

£2,077 per week, £9,000 per month + fees

 3 Bedrooms  3 Bathrooms  Furnished

Large, luxury apartment ,with outstanding design and modern conveniences, set within a highly prestigious development on the South banks of the River Thames, The Southbank within a short walk of The City and easy reach of The West End and Canary Wharf

Please [click here](#) for full detail

Property features

Three Bedroom luxury interior designed apartment | Large bedrooms with feature lighting and integrated storage | Underfloor heating & comfort cooling | Home automation - feature and mood lighting control | Wall mounted Sonos SoundBar system & flat screen TV | EPC-B | Residents pool and spa, gym, cinema and wine tasting room | Executive Lounge on 32nd floor with exceptional views | Sky garden & a dedicated 24h concierge | Moments from the Southbank, short walk to the City & close t

For more information about this property,
please call our City branch on

020 7213 9700

Redress & Client Money Protection :

Benham and Reeves are members of The Property Ombudsman redress scheme and have Client Money protection with ARLA Propertymark. You can find more information on our website at <https://www.benhams.com/membership/>



Benham & Reeves

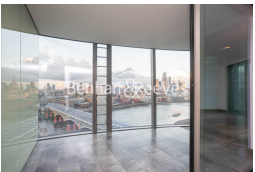

Blackfriars Road, City, SE1

£2,077 per week, £9,000 per month + fees

www.benhams.com

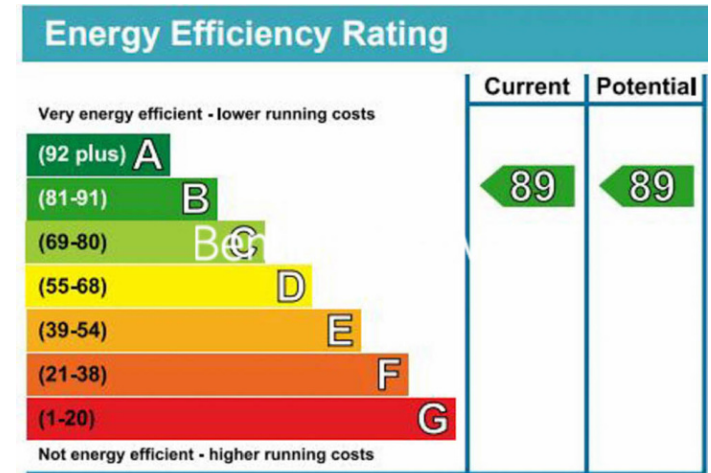
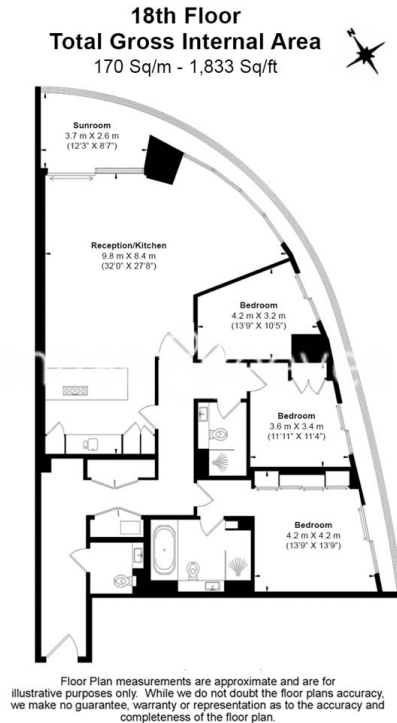

London branches open six days a week Mon - Sat

Canary Wharf | City | Colindale | Dartmouth Park | Ealing | Fulham
Hammersmith | Hampstead | Highgate | Hyde Park | Kensington | Kew
Knightsbridge | Nine Elms | Shoreditch | Southall | Surrey Quays
Wapping | Wembley | White City | Woolwich

International offices

China | Hong Kong SAR | India | Indonesia | Qatar | Malaysia | Middle East | Pakistan
Singapore | South Africa | Thailand | Turkey



Benham & Reeves