



Benham&Reeves

High Holborn, City, WC1V

£658 per week, £2,850 per month + fees

 1 Bedroom  1 Bathroom  Furnished

Spacious, 4th floor apartment in a highly desirable ported property in a transitional district. Located directly above Chancery Lane Central Line Station.

Please [click here](#) for full detail

Property features

Spacious One Bedroom Apartment | Bathroom | Open Plan Living Space | Fitted Kitchen | Furnished | EPC-C | Close to Amenities | Excellent Transport links Nearby | Nearby Chancery Road Tube Station

For more information about this property,
please call our City branch on

020 7213 9700

Redress & Client Money Protection :

Benham and Reeves are members of The Property Ombudsman redress scheme and have Client Money protection with ARLA Propertymark. You can find more information on our website at <https://www.benhams.com/membership/>



Benham&Reeves



High Holborn, City, WC1V

£658 per week, £2,850 per month + fees

www.benhams.com

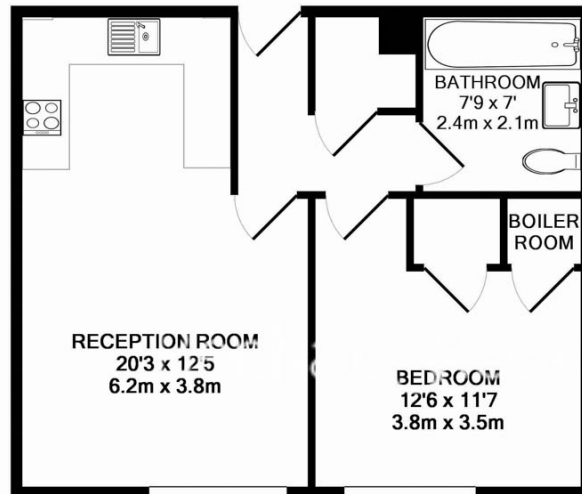

7HH.H.WC1V - 4TH FLOOR
TOTAL APPROX. FLOOR AREA 481 SQ.FT. (44.7 SQ.M.)

Whilst every attempt has been made to ensure the accuracy of the floor plan contained here, measurements of doors, windows, rooms and any other items are approximate and no responsibility is taken for any error, omission, or mis-statement. This plan is for illustrative purposes only and should be used as such by any prospective purchaser. The services, systems and appliances shown have not been tested and no guarantee as to their operability or efficiency can be given.
Made with Metropix ©2017

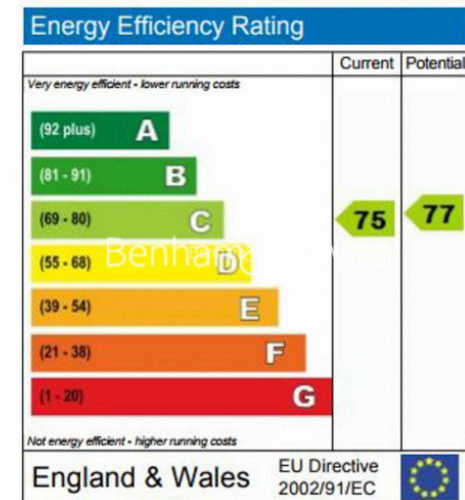

London branches open six days a week Mon - Sat

Canary Wharf | City | Colindale | Dartmouth Park | Ealing | Fulham
Hammersmith | Hampstead | Highgate | Hyde Park | Kensington | Kew
Knightsbridge | Nine Elms | Shoreditch | Southall | Surrey Quays
Wapping | Wembley | White City | Woolwich

International offices

China | Hong Kong SAR | India | Indonesia | Qatar | Malaysia | Middle East |
Singapore | South Africa | Thailand | Turkey



Benham & Reeves