



Benham & Reeves

**Boulevard Drive, Colindale, NW9**

£285 per week, £1,235 per month + fees

 Studio    1 Bathroom    Furnished

Modern 3rd floor Studio apartment situated within a premier development in North West London with excellent resident's amenities. Ideally located a short walk (0.4 miles) from Colindale Underground Station (Northern Line)

Please [click here](#) for full detail

## Property features

**Selection of Amenities On-site | Well Tended Communal Gardens | Tastefully Furnished | Private Balcony | Situated within Beaufort Park, Colindale NW9 | EPC-C | 24 Hour Estate Management | Water Rates Included | Fee Gym, Swimming Pool, Spa and Jacuzzi | 0.4 miles to Colindale Underground Station**

For more information about this property,  
please call our Colindale branch on

**020 8732 7980**

Redress & Client Money Protection :

Benham and Reeves are members of The Property Ombudsman redress scheme and have Client Money protection with ARLA Propertymark. You can find more information on our website at <https://www.benhams.com/membership/>



Benham&Reeves



# Boulevard Drive, Colindale, NW9

£285 per week, £1,235 per month + fees

[www.benhams.com](http://www.benhams.com)

Total Gross Internal Area  
23.2 Sq/m - 249 Sq/ft

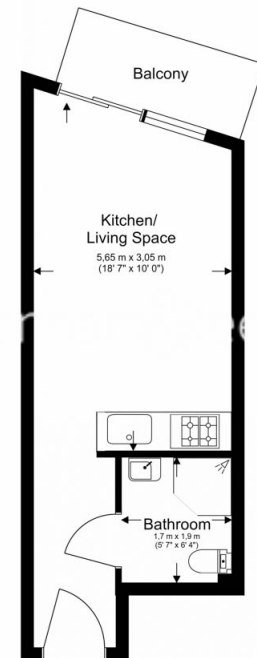

Floor Plan measurements are approximate and are for illustrative purposes only. While we do not doubt the floor plans accuracy, we make no guarantee, warranty or representation as to the accuracy and completeness of the floor plan.

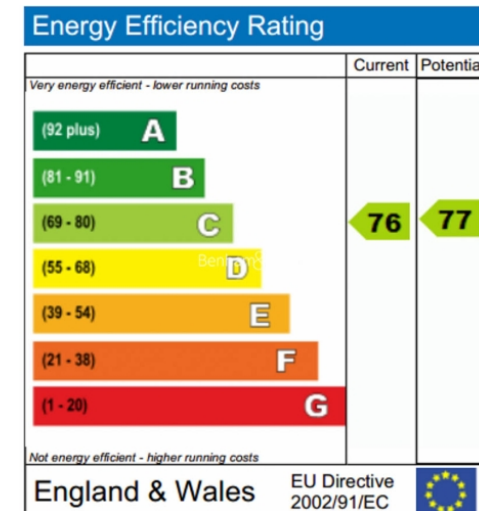

## London branches open six days a week Mon - Sat

Canary Wharf | City | Colindale | Dartmouth Park | Ealing | Fulham  
Hammersmith | Hampstead | Highgate | Hyde Park | Kensington | Kew  
Knightsbridge | Nine Elms | Shoreditch | Southall | Surrey Quays  
Wapping | Wembley | White City | Woolwich

## International offices

China | Hong Kong SAR | India | Indonesia | Qatar | Malaysia | Middle East | Pakistan  
Singapore | South Africa | Thailand | Turkey



Benham & Reeves