



Benham & Reeves

**Lingard Avenue, Colindale, NW9**

£300 per week, £1,300 per month + fees

 1 Bedroom    1 Bathroom    Furnished

Bright and airy 4th floor apartment, with allocated underground parking, situated in a desirable development in North West London. Conveniently located a short walk (0.2 miles) from Colindale Underground Station (Northern Line). EPC -B

**\*\*MORE PROPERTIES TO OFFER\*\***

Please [click here](#) for full detail

## Property features

**Selection of Amenities On-site | Well-Tended Communal Gardens | Private Balcony | Tastefully Furnished | Within the development of The Pulse | EPC-B | Secure Underground Allocated Parking Space | Secluded Fitted Kitchen | Direct Bus Route to Central London | 0.25 miles to Colindale Underground Station**

For more information about this property,  
please call our Colindale branch on

**020 8732 7980**

Redress & Client Money Protection :

Benham and Reeves are members of The Property Ombudsman redress scheme and have Client Money protection with ARLA Propertymark. You can find more information on our website at <https://www.benhamandreeves.com/membership/>



**Benham & Reeves**



# Lingard Avenue, Colindale, NW9

£300 per week, £1,300 per month + fees

www.benhams.com

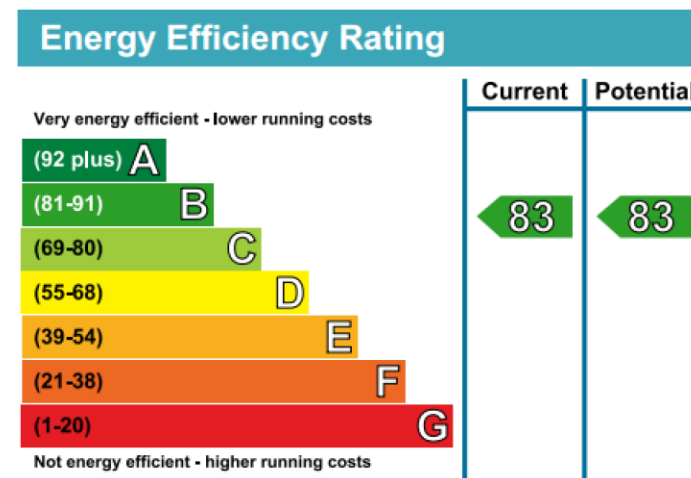
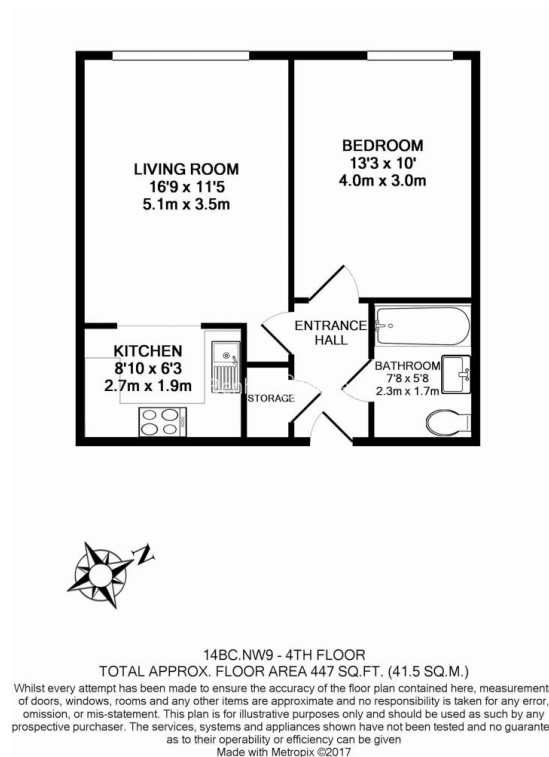

## London branches open six days a week Mon - Sat

Canary Wharf | City | Colindale | Dartmouth Park | Ealing | Fulham  
Hammersmith | Hampstead | Highgate | Hyde Park | Kensington | Kew  
Knightsbridge | Nine Elms | Shoreditch | Southall | Surrey Quays  
Wapping | Wembley | White City | Woolwich

## International offices

China | Hong Kong SAR | India | Indonesia | Qatar | Malaysia | Middle East |  
Singapore | South Africa | Thailand | Turkey



Benham & Reeves