



Benham&Reeves

Heritage Avenue, Colindale, NW9

£462 per week, £2,002 per month + fees

 2 Bedrooms  2 Bathrooms  Furnished

"**ON SITE AGENT**"

Spacious apartment, with Underground parking, situated within a popular and desirable development with good resident facilities in North West London. A brief 0.5 walk from Colindale Underground station (Northern Line). EPC - C

MORE PROPERTIES TO OFFER "

Please [click here](#) for full detail

Property features

Selection of Amenities On-site | Well Tended Communal Gardens | Private Balcony | Spacious Lounge | Situated within Beaufort Park, Colindale NW9 | EPC-C | 24 Hour Estate Management | Secure Underground Unallocated Parking | Gym, Swimming Pool, Spa and Jacuzzi | 0.4 miles to Colindale Underground Station

For more information about this property,
please call our Colindale branch on

020 8732 7980



Redress & Client Money Protection :
Benham and Reeves are members of The Property Ombudsman redress scheme and have Client Money protection with ARLA Propertymark.
You can find more information on our website at <https://www.benhams.com/membership/>

Benham & Reeves



Heritage Avenue, Colindale, NW9

£462 per week, £2,002 per month + fees

www.benhams.com

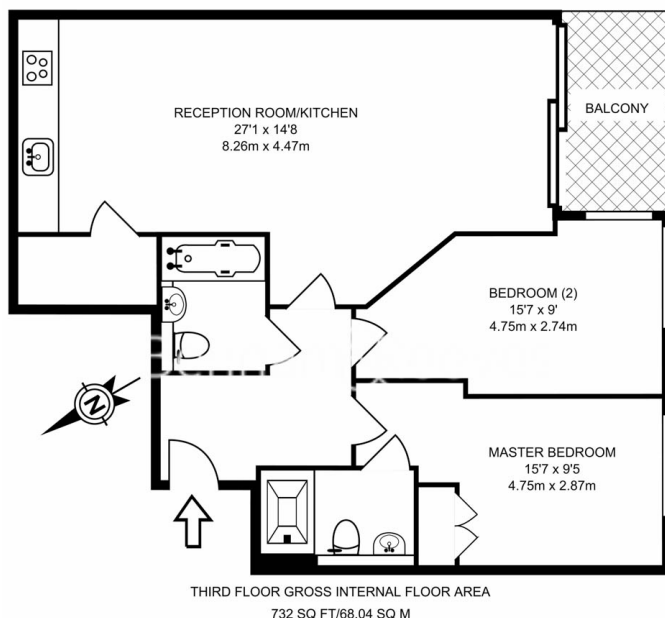

Score	Energy rating	Current	Potential
92+	A		
81-91	B		87 B
69-80	C	77 C	
55-68	D		
39-54	E		
21-38	F		
1-20	G		

London branches open six days a week Mon - Sat

Canary Wharf | City | Colindale | Dartmouth Park | Ealing | Fulham
Hammersmith | Hampstead | Highgate | Hyde Park | Kensington | Kew
Knightsbridge | Nine Elms | Shoreditch | Southall | Surrey Quays
Wapping | Wembley | White City | Woolwich

International offices

China | Hong Kong SAR | India | Indonesia | Qatar | Malaysia | Middle East | Pakistan
Singapore | South Africa | Thailand | Turkey



Benham & Reeves