



Benham & Reeves

Beaufort Square, Colindale, NW9

£531 per week, £2,301 per month + fees

 2 Bedrooms  2 Bathrooms  Furnished

A stylish, modern apartment with good security, situated in a desirable development with a host of onsite facilities. Located in North West London 0.4 miles on foot from Colindale Underground Station (Northern Line).

Please [click here](#) for full detail

Property features

2 Bed 2 Bath | Well Tended Communal Gardens | Private Balcony | New Development | Situated within Beaufort Park, Colindale NW9 | EPC-B | 24 Hour Estate Management | Water Rates Included | Fee Gym, Swimming Pool, Spa and Jacuzzi | 0.4 miles to Colindale Underground Station

For more information about this property,
please call our Colindale branch on

020 8732 7980

Redress & Client Money Protection :

Benham and Reeves are members of The Property Ombudsman redress scheme and have Client Money protection with ARLA Propertymark. You can find more information on our website at <https://www.benhams.com/membership/>



Benham & Reeves



Beaufort Square, Colindale, NW9

£531 per week, £2,301 per month + fees

www.benhams.com

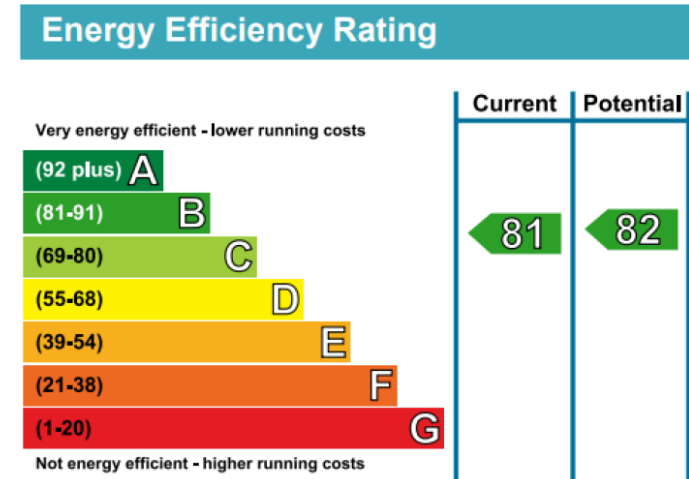
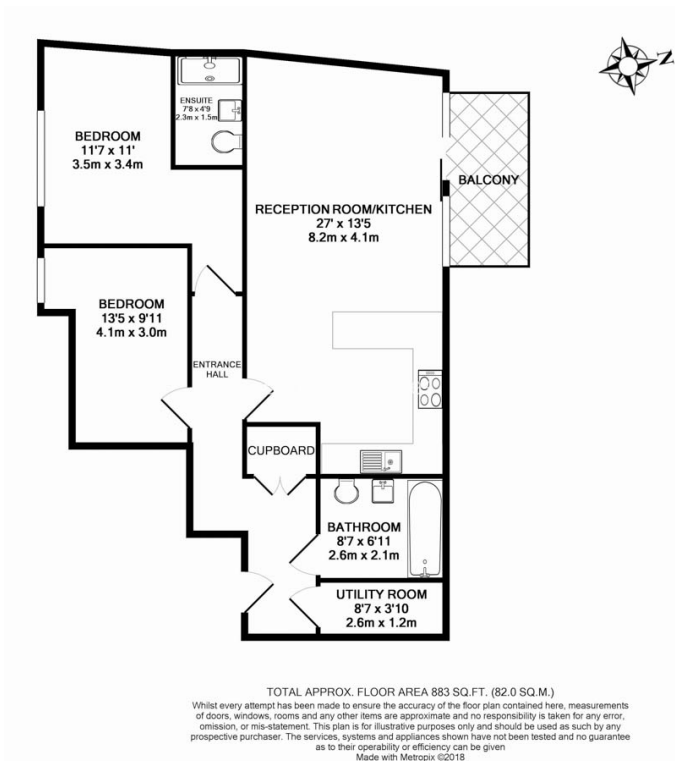

London branches open six days a week Mon - Sat

Canary Wharf | City | Colindale | Dartmouth Park | Ealing | Fulham
Hammersmith | Hampstead | Highgate | Hyde Park | Kensington | Kew
Knightsbridge | Nine Elms | Shoreditch | Southall | Surrey Quays
Wapping | Wembley | White City | Woolwich

International offices

China | Hong Kong SAR | India | Israel | Malaysia | Middle East | Pakistan
Qatar | Singapore | South Africa | Thailand | Turkey



Benham & Reeves