



Benham & Reeves

## **Trobridge Parade, Colindale, NW9**

£485 per week, £2,102 per month + fees

 2 Bedrooms    2 Bathrooms    Furnished

Bright stylish apartment, with parking, situated within a desirable development in North West London. Conveniently located 0.8 miles from Colindale Underground Station (Northern Line) and Mill Hill Broadway (Thames Link). EPC-

Please [click here](#) for full detail

## Property features

**South Facing | Well Tended Communal Gardens | Private Balcony | Tastefully Furnished | Situated within Trinity Square Colindale NW9 | EPC-B | Outstanding schools nearby | New build | 12 Mins walk to Mill Hill Broadway Station | 0.8 miles to Colindale underground station**

For more information about this property,  
please call our Colindale branch on

**020 8732 7980**

Redress & Client Money Protection :

Benham and Reeves are members of The Property Ombudsman redress scheme and have Client Money protection with ARLA Propertymark. You can find more information on our website at <https://www.benhams.com/membership/>



Benham & Reeves



# Trobridge Parade, Colindale, NW9

£485 per week, £2,102 per month + fees

[www.benhams.com](http://www.benhams.com)

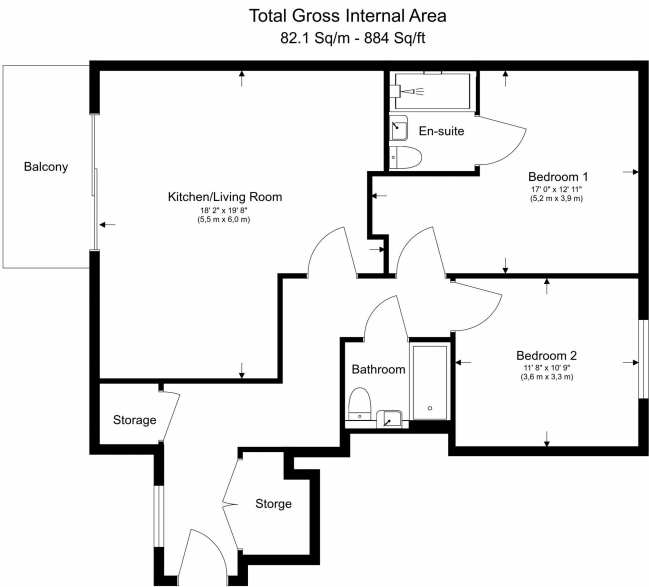

Floor Plan measurements are approximate and are for illustrative purposes only. While we do not doubt the floor plans accuracy, we make no guarantee, warranty or representation as to the accuracy and completeness of the floor plan.

Score	Energy rating	Current	Potential
92+	A		
81-91	B	91   B	91   B
69-80	C		
55-68	D		
39-54	E		
21-38	F		
1-20	G		

## London branches open six days a week Mon - Sat

Canary Wharf | City | Colindale | Dartmouth Park | Ealing | Fulham  
Hammersmith | Hampstead | Highgate | Hyde Park | Kensington | Kew  
Knightsbridge | Nine Elms | Shoreditch | Southall | Surrey Quays  
Wapping | Wembley | White City | Woolwich

## International offices

China | Hong Kong SAR | India | Indonesia | Qatar | Malaysia | Middle East | Pakistan  
Singapore | South Africa | Thailand | Turkey

