



Benham & Reeves

Heritage Avenue, Colindale, NW9

£450 per week, £1,950 per month + fees

 2 Bedrooms  1 Bathroom  Furnished

Bright, contemporary fourth floor apartment with range of onsite amenities in Colindale, North West London. Well-located a mere 0.4 miles from Colindale Underground station.

Please [click here](#) for full detail

Property features

Range of amenities on site | Communal Garden | Balcony | Fitted Kitchen | Furnished | EPC-B | 24 Hour Concierge | Water Rates Included | Gym Swimming Pool Spa and Jacuzzi | 0.4 miles to Colindale Underground Station

For more information about this property,
please call our Colindale branch on

020 8732 7980

Redress & Client Money Protection :

Benham and Reeves are members of The Property Ombudsman redress scheme and have Client Money protection with ARLA Propertymark. You can find more information on our website at <https://www.benhamandreeves.com/membership/>



Benham&Reeves



Heritage Avenue, Colindale, NW9

£450 per week, £1,950 per month + fees

www.benhams.com

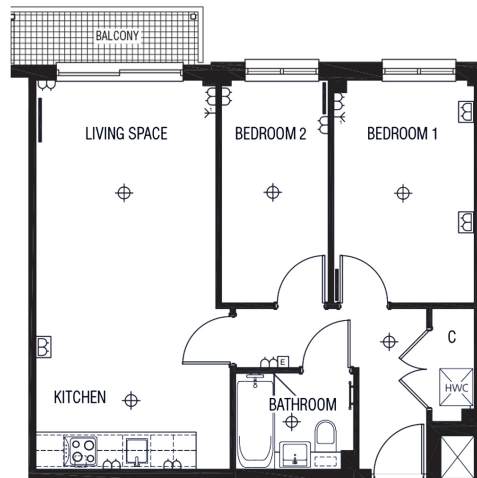

00292-45AH.BP.NW9 - 4th floor

Living Space	6.91m x 3.20m	22'8" x 10'6"
Bedroom 1	3.96m x 2.50m	13'0" x 8'2"
Bedroom 2	3.96m x 1.90m	13'0" x 6'3"

Energy Efficiency Rating		
	Current	Potential
Very energy efficient - lower running costs		
(92 plus) A		
(81-91) B	86	87
(69-80) C		
(55-68) D		
(39-54) E		
(21-38) F		
(1-20) G		
Not energy efficient - higher running costs		
England & Wales		EU Directive 2002/91/EC

London branches open six days a week Mon - Sat

Canary Wharf | City | Colindale | Dartmouth Park | Ealing | Fulham
Hammersmith | Hampstead | Highgate | Hyde Park | Kensington | Kew
Knightsbridge | Nine Elms | Shoreditch | Southall | Surrey Quays
Wapping | Wembley | White City | Woolwich

International offices

China | Hong Kong SAR | India | Indonesia | Qatar | Malaysia | Middle East |
Singapore | South Africa | Thailand | Turkey



Benham & Reeves