



Benham & Reeves

Lismore Boulevard, Colindale, NW9

£400 per week, £1,733 per month + fees

 2 Bedrooms  2 Bathrooms  Furnished

Newly built 3rd floor apartment located in a unique development in North West London set in over 9 acres of landscaped gardens, surrounding a 4-acre park. Located just 0.4 miles from Colindale Underground Station (Northern Line).

Please [click here](#) for full detail

Property features

Selection of Amenities On-site | Well Tended Communal Gardens | Private Balcony | Tastefully Furnished | Situated within Redrow, Colindale NW9 | EPC-B | Concierge Service | Set on the 3rd Floor | Free Gym on-site | 0.4 miles to Colindale Underground Station

For more information about this property,
please call our Property Management branch on

020 7319 9740

Redress & Client Money Protection :

Benham and Reeves are members of The Property Ombudsman redress scheme and have Client Money protection with ARLA Propertymark. You can find more information on our website at <https://www.benhamandreeves.com/membership/>



Benham & Reeves

Lismore Boulevard, Colindale, NW9

£400 per week, £1,733 per month + fees

www.benhams.com

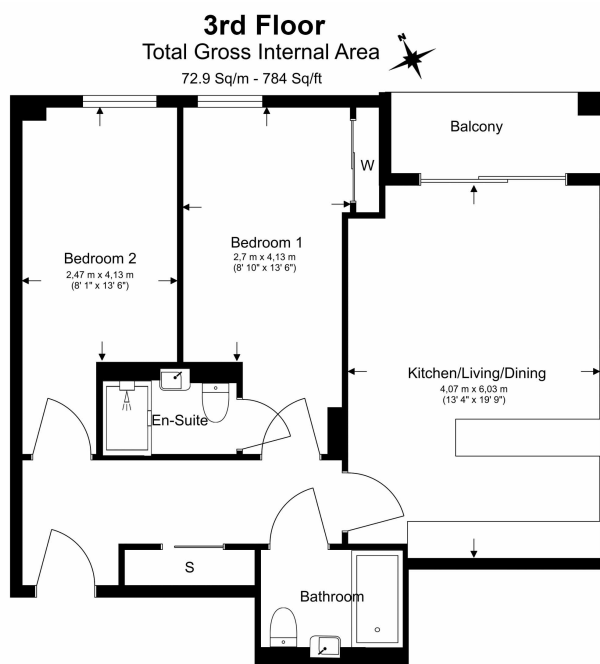

Floor Plan measurements are approximate and are for illustrative purposes only. While we do not doubt the floor plans accuracy, we make no guarantee, warranty or representation as to the accuracy and completeness of the floor plan.

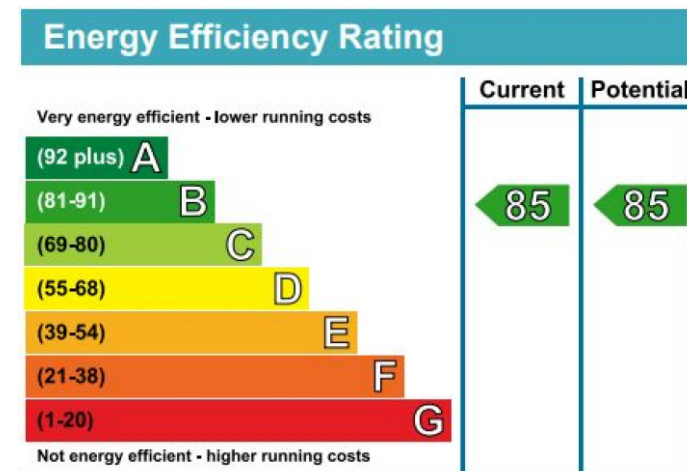

London branches open six days a week Mon - Sat

Canary Wharf | City | Colindale | Dartmouth Park | Ealing | Fulham
Hammersmith | Hampstead | Highgate | Hyde Park | Kensington | Kew
Knightsbridge | Nine Elms | Shoreditch | Southall | Surrey Quays
Wapping | Wembley | White City | Woolwich

International offices

China | Hong Kong SAR | India | Indonesia | Qatar | Malaysia | Middle East |
Singapore | South Africa | Thailand | Turkey



Benham & Reeves