



Benham & Reeves

**Kings Mill Way, Denham, UB9**

£427 per week, £1,850 per month + fees

 2 Bedrooms    2 Bathrooms    Furnished

A contemporary first floor apartment situated within a private community well positioned for the Metropolitan and Piccadilly line stations and the A40/M40 and M25 are easy to reach.

Please [click here](#) for full detail

## Property features

**2 bedrooms | 2 Bathrooms | Terrace | Balcony | Parking | EPC-C | Gated development | Close to local Amenities | Nearby Metropolitan and Piccadilly line stations.**

For more information about this property, please call our Southall branch on

**020 8051 0800**

Redress & Client Money Protection :

Benham and Reeves are members of The Property Ombudsman redress scheme and have Client Money protection with ARLA Propertymark. You can find more information on our website at <https://www.benhams.com/membership/>



**Benham & Reeves**



# Kings Mill Way, Denham, UB9

£427 per week, £1,850 per month + fees

www.benhams.com

**Kings Mill Way, Denham, Uxbridge, UB9**  
 Approximate Area = 694 sq ft / 64.4 sq m  
For identification only - Not to scale

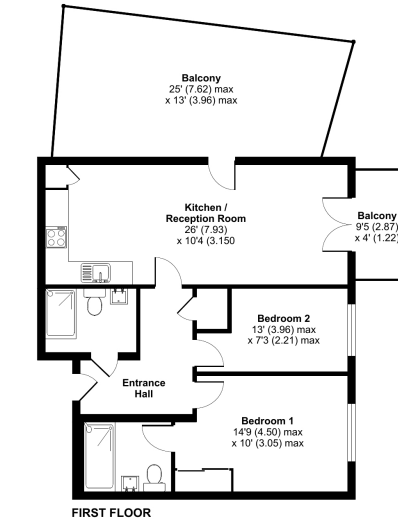

ⓘ Floor plan produced in accordance with RICS Property Measurement 2nd Edition, incorporating International Property Measurement Standards (IPMS) (Residential). © nrlhcom 2025. Produced for Benham & Reeves. REF: 1244321

Score	Energy rating	Current	Potential
92+	A		
81-91	B		
69-80	C	80 C	80 C
55-68	D		
39-54	E		
21-38	F		
1-20	G		

## London branches open six days a week Mon - Sat

Canary Wharf | City | Colindale | Dartmouth Park | Ealing | Fulham  
 Hammersmith | Hampstead | Highgate | Hyde Park | Kensington | Kew  
 Knightsbridge | Nine Elms | Shoreditch | Southall | Surrey Quays  
 Wapping | Wembley | White City | Woolwich

## International offices

China | Hong Kong SAR | India | Indonesia | Qatar | Malaysia | Middle East |  
 Singapore | South Africa | Thailand | Turkey

