



Benham & Reeves

## **Longfield Avenue, Ealing W5**

£693 per week, £3,003 per month + fees

 2 Bedrooms    2 Bathrooms    Furnished

Spacious 7th floor apartment situated within a popular Ealing development ideally located close to open spaces, shops, and Ealing Broadway (Elizabeth, Circle and District lines) underground and Overground stations.

Please [click here](#) for full detail

## Property features

**2 Bedrooms | 2 Bathrooms | Reception | Furnished | Fitted Kitchen | EPC-B | Concierge | Gym & Swimming pool | Private Balcony | Nearby Ealing Broadway Tube Station**

For more information about this property,  
please call our Property Management branch on

**020 7319 9740**

Redress & Client Money Protection :

Benham and Reeves are members of The Property Ombudsman redress scheme and have Client Money protection with ARLA Propertymark. You can find more information on our website at <https://www.benhams.com/membership/>



Benham&Reeves



# Longfield Avenue, Ealing W5

£693 per week, £3,003 per month + fees

[www.benhamshams.com](http://www.benhamshams.com)

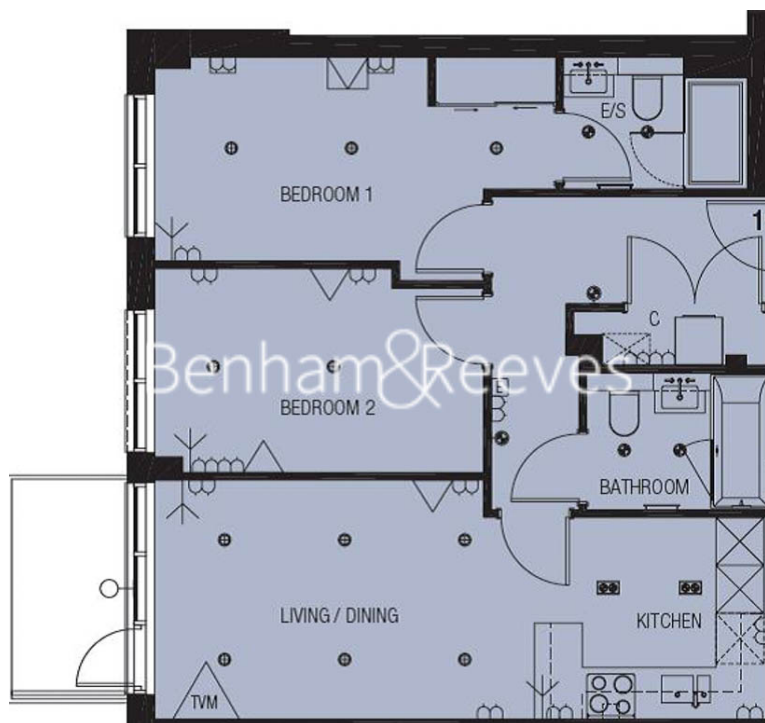

Score	Energy rating	Current	Potential
92+	A		
81-91	B	82 B	84 B
69-80	C		
55-68	D		
39-54	E		
21-38	F		
1-20	G		

## London branches open six days a week Mon - Sat

Canary Wharf | City | Colindale | Dartmouth Park | Ealing | Fulham  
Hammersmith | Hampstead | Highgate | Hyde Park | Kensington | Kew  
Knightsbridge | Nine Elms | Shoreditch | Southall | Surrey Quays  
Wapping | Wembley | White City | Woolwich

## International offices

China | Hong Kong SAR | India | Indonesia | Qatar | Malaysia | Middle East |  
Singapore | South Africa | Thailand | Turkey



Benham&Reeves