



Benham & Reeves

## **Longfield Avenue, Ealing, W5**

£508 per week, £2,201 per month + fees

 1 Bedroom    1 Bathroom    Furnished

A modern 2nd floor apartment situated within a popular development with onsite residents' spa, gym, and pool, in the heart of Ealing Broadway. Located a short walk from Ealing Broadway (Elizabeth, Central and District lines) underground and Overground station.

Please [click here](#) for full detail

## Property features

**1 Bedroom | 1 Bathroom | Reception | Furnished | Wood Floors | EPC-B | Balcony | Swimming pool & Gym | 24hr Concierge | Nearby Ealing Broadway Overground Station**

For more information about this property,  
please call our Ealing branch on

**020 8280 0140**

Redress & Client Money Protection :

Benham and Reeves are members of The Property Ombudsman redress scheme and have Client Money protection with ARLA Propertymark. You can find more information on our website at <https://www.benhamandreeves.com/membership/>



**Benham & Reeves**



# Longfield Avenue, Ealing, W5

£508 per week, £2,201 per month + fees

[www.benhams.com](http://www.benhams.com)

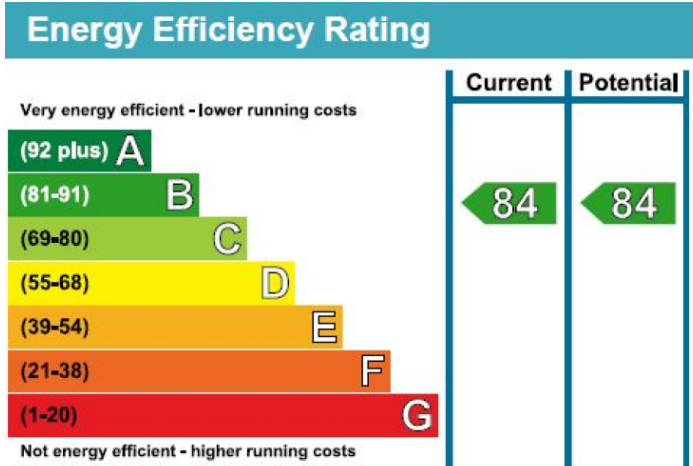
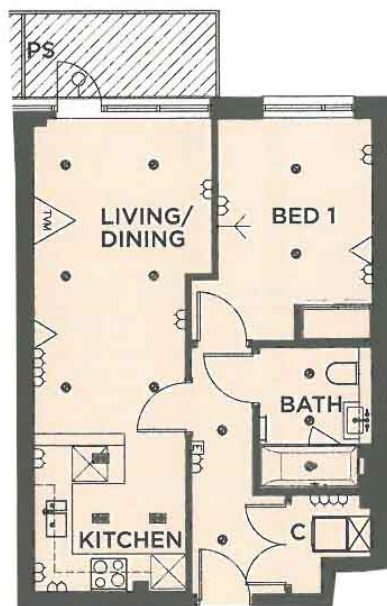

## London branches open six days a week Mon - Sat

Canary Wharf | City | Colindale | Dartmouth Park | Ealing | Fulham  
Hammersmith | Hampstead | Highgate | Hyde Park | Kensington | Kew  
Knightsbridge | Nine Elms | Shoreditch | Southall | Surrey Quays  
Wapping | Wembley | White City | Woolwich

## International offices

China | Hong Kong SAR | India | Indonesia | Qatar | Malaysia | Middle East |  
Singapore | South Africa | Thailand | Turkey



Benham & Reeves