



Benham & Reeves

## **Uxbridge Road, Ealing, W5**

£416 per week, £1,803 per month + fees

 1 Bedroom    1 Bathroom    Furnished

A bright 10th floor apartment situated in a popular Tower development in Ealing. Ideally located within walking distance from Ealing Broadway Underground Station (Central & District Lines).

Please [click here](#) for full detail

## Property features

**1 Bedroom | 1 Bathroom | Reception | Furnished | Fitted kitchen | EPC-B | Concierge | Balcony | Nearby Ealing Broadway Station**

For more information about this property,  
please call our Ealing branch on

**020 8280 0140**

Redress & Client Money Protection :

Benham and Reeves are members of The Property Ombudsman redress scheme and have Client Money protection with ARLA Propertymark. You can find more information on our website at <https://www.benhams.com/membership/>



**Benham & Reeves**



# Uxbridge Road, Ealing, W5

£416 per week, £1,803 per month + fees

www.benhams.com

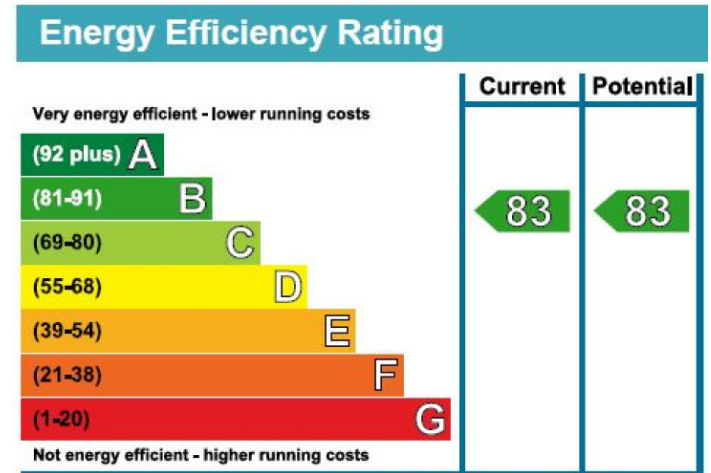
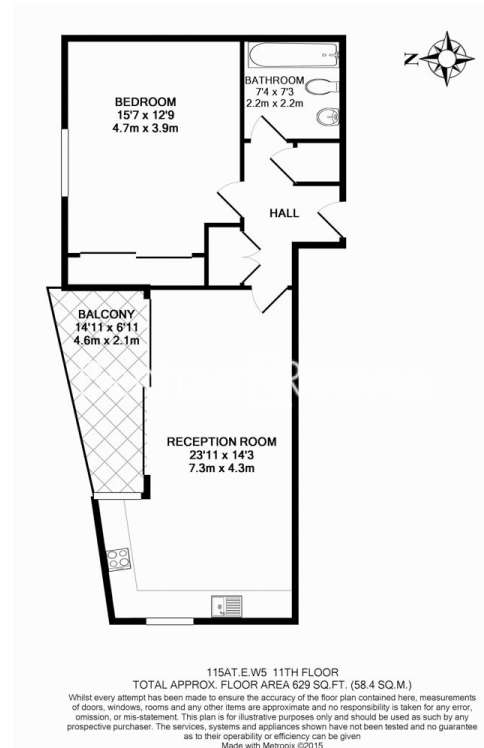

## London branches open six days a week Mon - Sat

Canary Wharf | City | Colindale | Dartmouth Park | Ealing | Fulham  
Hammersmith | Hampstead | Highgate | Hyde Park | Kensington | Kew  
Knightsbridge | Nine Elms | Shoreditch | Southall | Surrey Quays  
Wapping | Wembley | White City | Woolwich

## International offices

China | Hong Kong SAR | India | Indonesia | Qatar | Malaysia | Middle East | Pakistan  
Singapore | South Africa | Thailand | Turkey



Benham & Reeves