



Benham & Reeves

Barrow Hill Estate, Charlbert Street, NW8

£750 per week, £3,250 per month + fees

 3 Bedrooms  2 Bathrooms  Furnished

A large well-proportioned split-level garden flat situated close to amenities of St John's Wood, the property is a stone throw away from St John's Wood Station and Regent's Park.

Please [click here](#) for full detail

Property features

Three sizeable bedrooms | Set within an imposing purpose-built block | Large reception room | Wood floors | Smart deluxe kitchen | EPC-D | Ample storage | Utility room | Walking distance to St John's wood station and Regents Park

For more information about this property,
please call our Hampstead branch on

020 7435 9681

Redress & Client Money Protection :

Benham and Reeves are members of The Property Ombudsman redress scheme and have Client Money protection with ARLA Propertymark. You can find more information on our website at <https://www.benhamandreeves.com/membership/>



Benham&Reeves



Barrow Hill Estate, Charlbert Street, NW8

£750 per week, £3,250 per month + fees

www.benhams.com

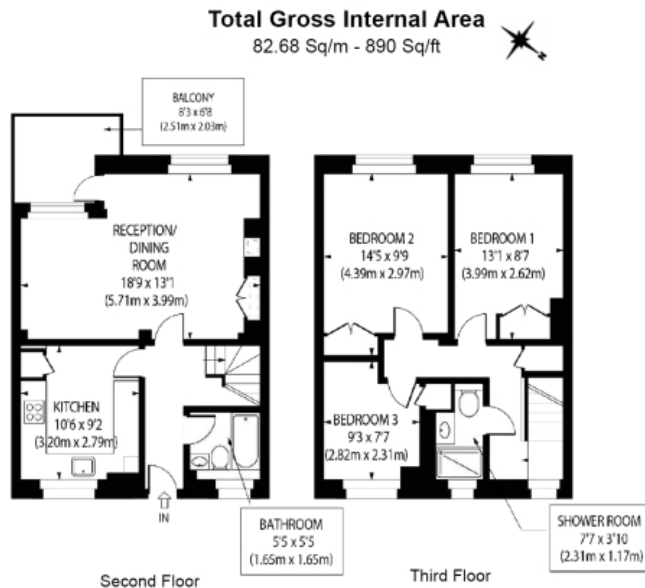

Floor Plan measurements are approximate and are for illustrative purposes only. While we do not doubt the floor plans accuracy, we make no guarantee, warranty or representation as to the accuracy and completeness of the floor plan.

Score	Energy rating	Current	Potential
92+	A		
81-91	B		
69-80	C		80 C
55-68	D	66 D	
39-54	E		
21-38	F		
1-20	G		

London branches open six days a week Mon - Sat

Canary Wharf | City | Colindale | Dartmouth Park | Ealing | Fulham
Hammersmith | Hampstead | Highgate | Hyde Park | Kensington | Kew
Knightsbridge | Nine Elms | Shoreditch | Southall | Surrey Quays
Wapping | Wembley | White City | Woolwich

International offices

China | Hong Kong SAR | India | Indonesia | Qatar | Malaysia | Middle East | Pakistan
Singapore | South Africa | Thailand | Turkey

