



Benham & Reeves

Earlington Court, Earls Court, SW5

£497 per week, £2,154 per month + fees

 1 Bedroom  1 Bathroom  Furnished

An exceptional recently refurbished 3rd floor apartment situated in a meticulously renovated Victorian Period building on a tranquil residential street close to Earls Court Underground (Circle, District & Piccadilly Lines).

Please [click here](#) for full detail

Property features

1 Bedroom | 1 Bathroom | Reception | Furnished | Separate Kitchen | EPC-C | Close to public transport | Close to Amenities | Nearby Underground station of Earls Court

For more information about this property, please call our Kensington branch on

020 7938 3522

Redress & Client Money Protection :

Benham and Reeves are members of The Property Ombudsman redress scheme and have Client Money protection with ARLA Propertymark. You can find more information on our website at <https://www.benhams.com/membership/>



Benham & Reeves

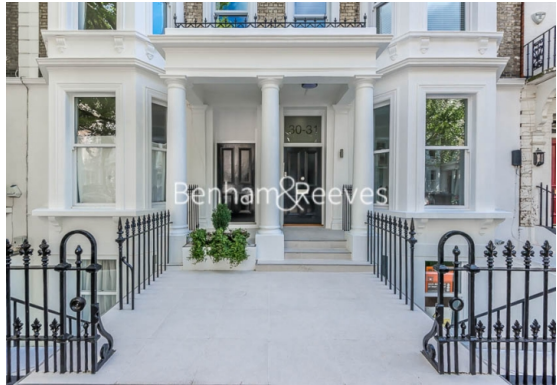

Earlington Court, Earls Court, SW5

£497 per week, £2,154 per month + fees

www.benhams.com

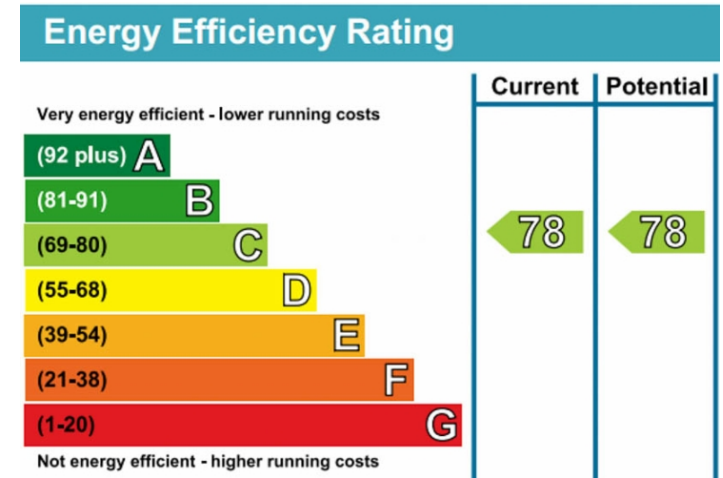
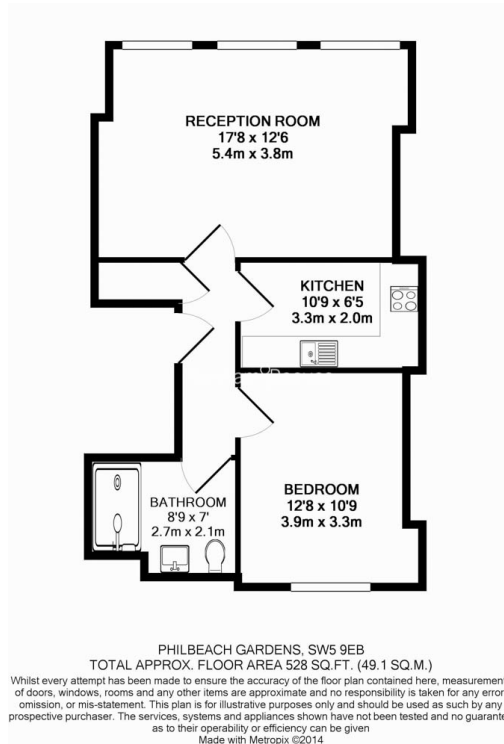

London branches open six days a week Mon - Sat

Canary Wharf | City | Colindale | Dartmouth Park | Ealing | Fulham
Hammersmith | Hampstead | Highgate | Hyde Park | Kensington | Kew
Knightsbridge | Nine Elms | Shoreditch | Southall | Surrey Quays
Wapping | Wembley | White City | Woolwich

International offices

China | Hong Kong SAR | India | Indonesia | Qatar | Malaysia | Middle East |
Singapore | South Africa | Thailand | Turkey

