



Benham & Reeves

Kingston House South, Ennismore Gardens, SW7

£2,200 per week, £9,533 per month + fees

 3 Bedrooms  2 Bathrooms  Furnished

A beautiful 1,322 sq ft, THREE-BEDROOM apartment with PRIVATE BALCONY & access to a communal garden covering two acres, and situated within an elegant building in ENNISMORE GARDENS a desirable KNIGHTSBRIDGE location.

Please [click here](#) for full detail

Property features

3 Bedrooms | 2 Bathrooms | Reception | Furnished | Fitted Kitchen | EPC-C | 1,322 Sq Ft | Balcony & Communal Gardens | 24 Hour Porterage & Lift | Nearby South Kensington Underground Station

For more information about this property, please call our Knightsbridge branch on

020 7581 2112

Redress & Client Money Protection :

Benham and Reeves are members of The Property Ombudsman redress scheme and have Client Money protection with ARLA Propertymark. You can find more information on our website at <https://www.benhams.com/membership/>



Benham & Reeves



Kingston House South, Ennismore Gardens, SW7

www.benhams.com

£2,200 per week, £9,533 per month + fees

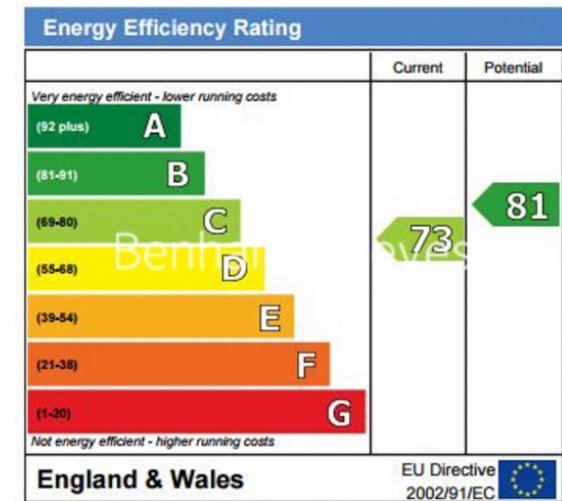
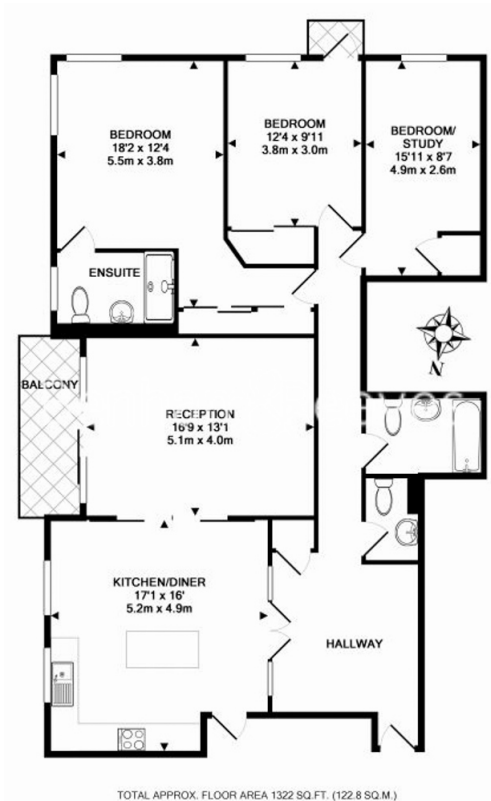

London branches open six days a week Mon - Sat

Canary Wharf | City | Colindale | Dartmouth Park | Ealing | Fulham
Hammersmith | Hampstead | Highgate | Hyde Park | Kensington | Kew
Knightsbridge | Nine Elms | Shoreditch | Southall | Surrey Quays
Wapping | Wembley | White City | Woolwich

International offices

China | Hong Kong SAR | India | Indonesia | Qatar | Malaysia | Middle East |
Singapore | South Africa | Thailand | Turkey



Benham & Reeves