



Benham & Reeves

Navigation Point, Ferry Lane, N17

£360 per week, £1,560 per month + fees

 1 Bedroom  1 Bathroom  Furnished

Stunning brand-new designer furnished apartment situated in a new development in N17, located on the banks of the River Lea, a stone's throw from Walthamstow Wetlands and Tottenham Hale Station.

Please [click here](#) for full detail

Property features

One Double Bedroom | Modern Fully Fitted Open Plan Kitchen | One Family Batrooms | Private Balcony With Great View | Lifts | EPC-B | Furnished By Interior Designer Company | Close To Local Amenities | Close To Tube Station

For more information about this property,
please call our Highgate branch on

020 8341 2335

Redress & Client Money Protection :

Benham and Reeves are members of The Property Ombudsman redress scheme and have Client Money protection with ARLA Propertymark. You can find more information on our website at <https://www.benhams.com/membership/>

Benham&Reeves



Navigation Point, Ferry Lane, N17

£360 per week, £1,560 per month + fees

www.benhams.com

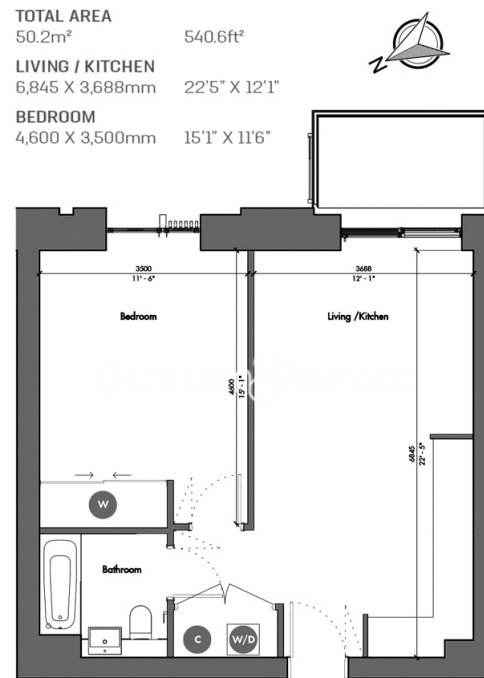

Whilst every attempt has been made to ensure the accuracy of the floor plan contained here, measurements of doors, windows, rooms and any other items are approximate and no responsibility is taken for any error, omission, or mis-statement. This plan is for illustrative purposes only and should be used as such by any prospective purchaser. The services, systems and appliances shown have not been tested and no guarantee as to their operability or efficiency can be given.
Made with Metropix 6/2016

London branches open six days a week Mon - Sat

Canary Wharf | City | Colindale | Dartmouth Park | Ealing | Fulham
Hammersmith | Hampstead | Highgate | Hyde Park | Kensington | Kew
Knightsbridge | Nine Elms | Shoreditch | Southall | Surrey Quays
Wapping | Wembley | White City | Woolwich

International offices

China | Hong Kong SAR | India | Israel | Malaysia | Middle East | Pakistan
Qatar | Singapore | South Africa | Thailand | Turkey



Benham & Reeves