



Benham&Reeves

**Parker Building, Freda Street, SE16**

£577 per week, £2,500 per month + fees

🛏️ 2 Bedrooms    🚿 2 Bathrooms    🛋️ Furnished

"Elegant 4th floor apartment, with negotiable parking space, close to the amenities of Shad Thames, and within a short walk of Bermondsey Station (Jubilee Line).

Please [click here](#) for full detail

## Property features

**2 Bedrooms | 2 Bathrooms | Reception | Furnished | Fitted Kitchen | EPC-B | 696 Sq Ft | Underground Parking (Separate Negotiation) | Wood Floors | Nearby Bermondsey Tube Station**

For more information about this property, please call our Surrey Quays branch on

**020 7740 3050**

Redress & Client Money Protection :

Benham and Reeves are members of The Property Ombudsman redress scheme and have Client Money protection with ARLA Propertymark. You can find more information on our website at <https://www.benhamandreeves.com/membership/>



Benham & Reeves



# Parker Building, Freda Street, SE16

£577 per week, £2,500 per month + fees

www.benhams.com

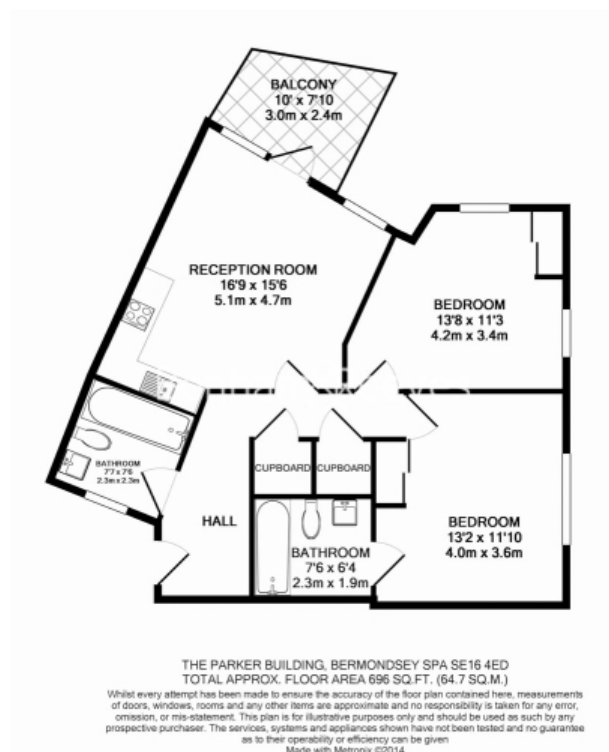

## Energy Efficiency Rating

Very energy efficient - lower running costs

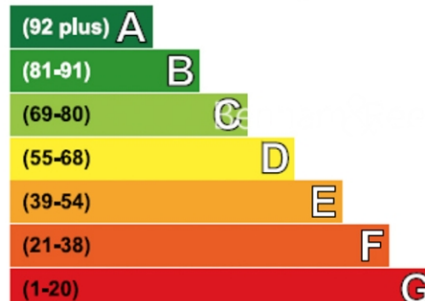

Not energy efficient - higher running costs

## London branches open six days a week Mon - Sat

Canary Wharf | City | Colindale | Dartmouth Park | Ealing | Fulham  
Hammersmith | Hampstead | Highgate | Hyde Park | Kensington | Kew  
Knightsbridge | Nine Elms | Shoreditch | Southall | Surrey Quays  
Wapping | Wembley | White City | Woolwich

## International offices

China | Hong Kong SAR | India | Indonesia | Qatar | Malaysia | Middle East |  
Singapore | South Africa | Thailand | Turkey



Benham & Reeves