



Benham & Reeves

The Boulevard, Fulham, SW6

£692 per week, £2,999 per month + fees

🛏 2 Bedrooms 🚿 2 Bathrooms 🛋 Furnished

Stunning 9th floor apartment situated in a highly sought-after development which is located along one of the most dramatic stretches of the River Thames. The development benefits from its own mainline train station: Imperial Wharf.

Please [click here](#) for full detail

Property features

2 Bedrooms | 2 Bathrooms | Reception | Furnished | Kitchen | EPC-C | 24 hour concierge | Balcony | Nearby St George Landmark Tube Station

For more information about this property,
please call our Fulham branch on

020 7348 7620

Redress & Client Money Protection :

Benham and Reeves are members of The Property Ombudsman redress scheme and have Client Money protection with ARLA Propertymark. You can find more information on our website at <https://www.benhamandreeves.com/membership/>



Benham & Reeves



The Boulevard, Fulham, SW6

£692 per week, £2,999 per month + fees

www.benhams.com

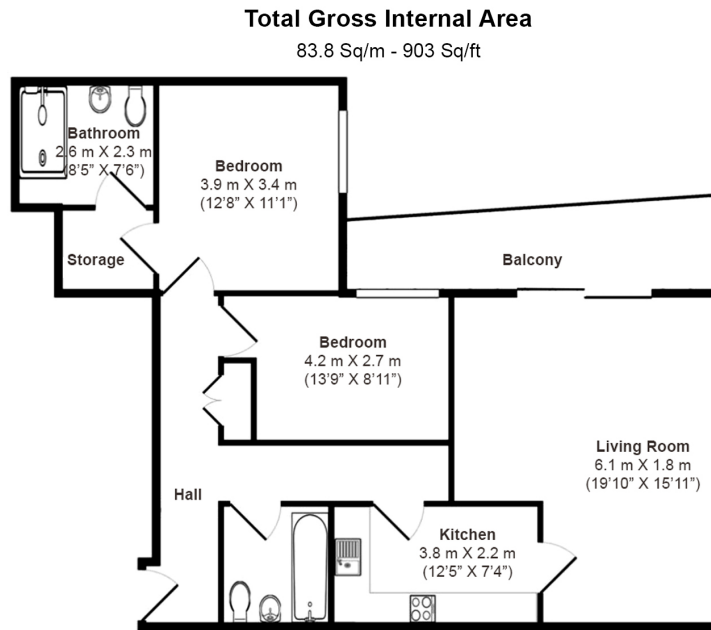

Floor Plan measurements are approximate and are for illustrative purposes only. While we do not doubt the floor plans accuracy, we make no guarantee, warranty or representation as to the accuracy and completeness of the floor plan.

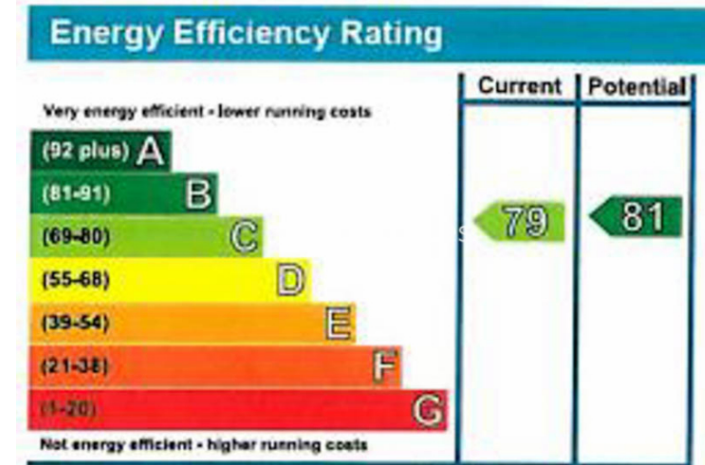

London branches open six days a week Mon - Sat

Canary Wharf | City | Colindale | Dartmouth Park | Ealing | Fulham
Hammersmith | Hampstead | Highgate | Hyde Park | Kensington | Kew
Knightsbridge | Nine Elms | Shoreditch | Southall | Surrey Quays
Wapping | Wembley | White City | Woolwich

International offices

China | Hong Kong SAR | India | Indonesia | Qatar | Malaysia | Middle East | Pakistan
Singapore | South Africa | Thailand | Turkey



Benham & Reeves