



Benham & Reeves

Imperial Wharf, Fulham, SW6

£1,700 per week, £7,367 per month + fees

 3 Bedrooms  3 Bathrooms  Furnished

Large contemporary apartment situated in a vibrant, popular Riverside development with a range of onsite amenities, stone's throw from Imperial Wharf Overground Station.

Please [click here](#) for full detail

Property features

3 Bedrooms | 3 Bathrooms | Reception | Furnished | Fitted Kitchen | EPC-B | 24hr Concierge & Gym | Balcony | Nearby Imperial Wharf Overground station

For more information about this property,
please call our Fulham branch on

020 7348 7620

Redress & Client Money Protection :

Benham and Reeves are members of The Property Ombudsman redress scheme and have Client Money protection with ARLA Propertymark. You can find more information on our website at <https://www.benhams.com/membership/>



Benham & Reeves



Imperial Wharf, Fulham, SW6

£1,700 per week, £7,367 per month + fees

www.benhams.com

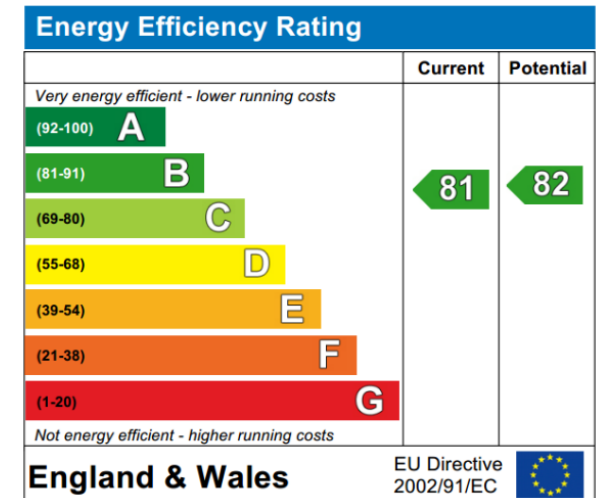
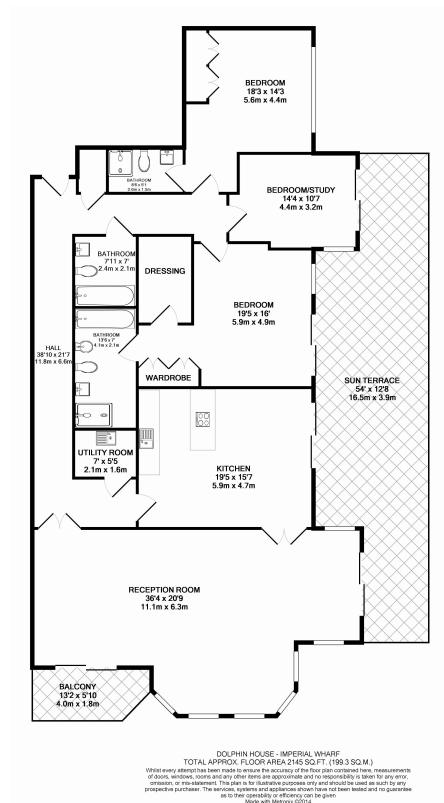

London branches open six days a week Mon - Sat

Canary Wharf | City | Colindale | Dartmouth Park | Ealing | Fulham
Hammersmith | Hampstead | Highgate | Hyde Park | Kensington | Kew
Knightsbridge | Nine Elms | Shoreditch | Southall | Surrey Quays
Wapping | Wembley | White City | Woolwich

International offices

China | Hong Kong SAR | India | Indonesia | Qatar | Malaysia | Middle East | Pakistan
Singapore | South Africa | Thailand | Turkey



Benham & Reeves